

Monday, 30.June 2008

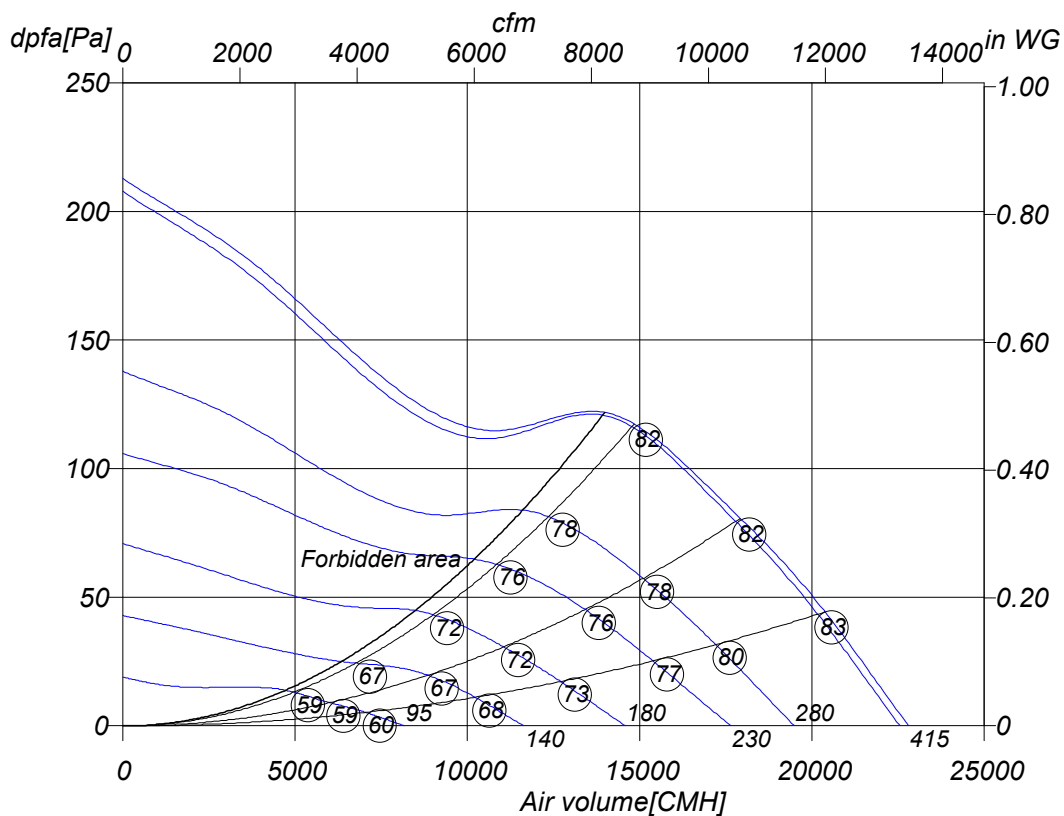

## Axial fan



DQ 800-6	
Art. No.	E00-80080
U[V]	400 D
f[Hz]	50
P[kW]	1.3
I[A]	2.6
n[1/min]	845
C[μF]	-
tR[°C]	70
dpst[Pa]	-
Delta I[%]	-
Ia/In	2.9
IP	54
Weight[kG]	37
Wir. diagr.	01.006

○ Sound power level  
LwA6[dBA]

### Octave sound power level

f[Hz]	125	250	500	1000	2000	4000	8000
LwA6[dBA]:	-13	-9	-6	-4	-5	-10	-18

Monday, 30.June 2008



**Axial fan**

## DQ 800-6

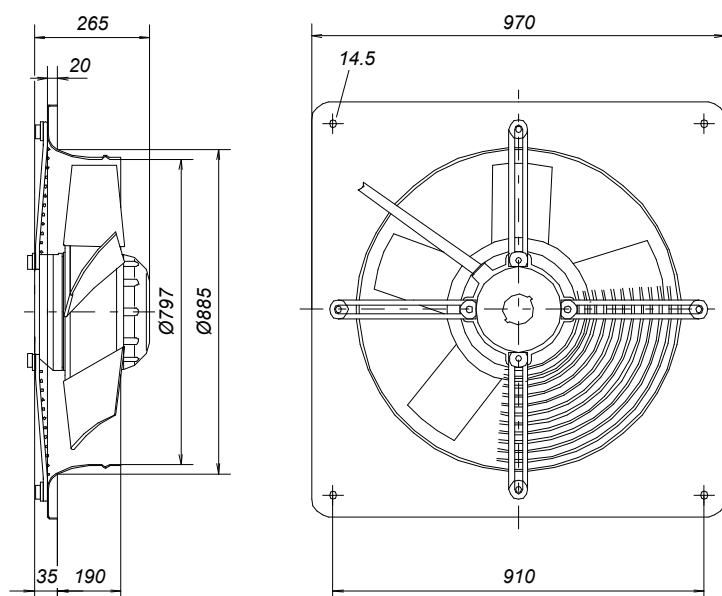

Monday, 30.June 2008

Pos.	Pieces	Description	Price
		<p><i>Rosenberg high efficiency axial fans in low pressure execution</i></p> <p><i>Casing made from galvanized and plastic-coated steel, EQ/DQ series plate mounted, ER/DR series short cased with two flanges.</i></p> <p><i>Impellers with aerodynamically shaped blades, up to size 300 made from galvanized steel, from size 315 up to size 630-6 made from plastic, from size 630-4 from die-cast aluminium, mounted onto a speed controllable external rotor motor. The fan is balanced on two levels according to quality level G 2.5 DIN/ISO 1940.</i></p> <p><i>Closed motor, protection class IP 44/54 with protection against humidity and thermal contacts wired in windings for motor protection from size 315.</i></p> <p><i>Maintenance free ball bearings closed on both sides, sealed for life. Electrical connection through terminal box (not connected) in IP 44.</i></p> <p><i>Documentation:</i>  <i>Manufacturers declaration and operating instruction are according to machinery directive 89/392/EEC, CE identification in accordance to EMC-directive 89/336/EEC and low voltage directive 73/23/EEC. Motor operating instruction are available from motor manufacturer.</i></p>	
		<p><b>Nominal data</b></p> <p>Type DQ 800-6</p> <p>Article no. E00-80080</p> <p>Voltage[V] 400 D</p> <p>Frequency[Hz] 50</p> <p>Power P1[kW] 1.3</p> <p>Current I[A] 2.6</p> <p>Speed n[1/min] 845</p> <p>Capacitor C[μF] -</p> <p>Max. air temp.tR[°C] 70</p> <p>Min. pressure dpst[Pa] -</p> <p>Delta I[%] -</p> <p>Startup current Ia/In 2.9</p> <p>Protection-mode IP 54</p> <p>Weight[kg] 37</p> <p>wiring diagram 01.006</p>	

Monday, 30.June 2008



**Axial fan**

## DQ 800-6

Drehstrommotor in  $\Delta$ -Schaltung mit Thermokontakt.  
Drehrichtungsänderung durch Vertauschen von 2 Phasen.

**Three phase motor in delta connection with thermal contact. Changing of rotation direction by interchanging of 2 phases.**

***Moteur triphasé branché en triangle avec thermocontact. Changement de sens de rotation par inversion de deux phases.***

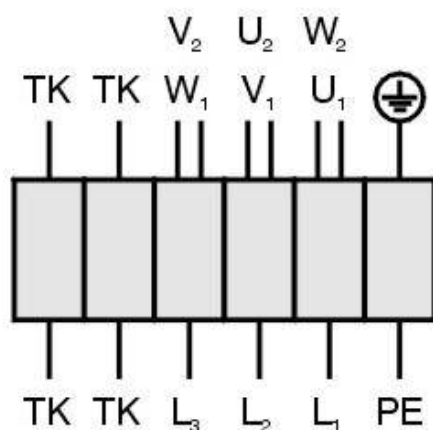

U <sub>1</sub>	braun / brown / brun
V <sub>1</sub>	blau / blue / bleu
W <sub>1</sub>	schwarz / black / noir
U <sub>2</sub>	rot / red / rouge
V <sub>2</sub>	grau / grey / gris
W <sub>2</sub>	orange / orange / orange
TK	weiß / white / blanc
PE	gelb-grün yellow-green jaun-vert

01.006

TK3-20004