

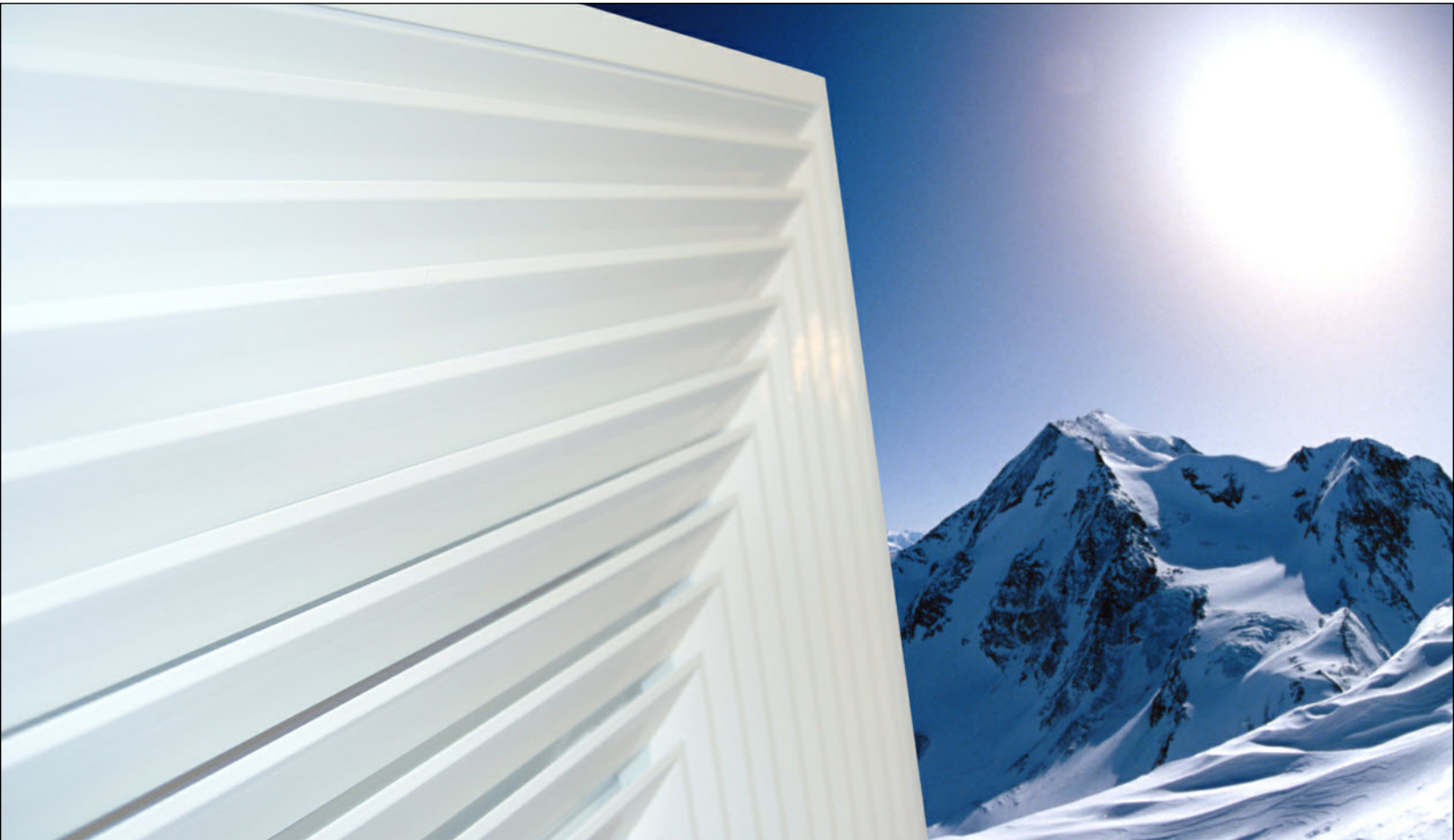

Incorporating



V2.2



Product spec >>>

> Series CD - Ceiling diffusers

Diffusers

Ceiling (Louvre faced)

Recommended for:

Ceiling

Supply

Overview

*Excellent diffusion characteristics
CD4 tile replacers normally in stock*

Now with a shallower profile, new blade design and hence a lighter weight, HVC Series CD Louvre faced ceiling diffusers blend seamlessly into modern office and commercial building ceilings.

Custom blow patterns can be created through the use of our five blow formats.

Free area:	50%
Mass/M sq face area:	8.5 kg
Mass/M sq face area inc OBD:	16 kg



Specifications:

Materials:	Extruded aluminium throughout.
Construction:	Frames have punched in corners, in addition to welded joints. Welded blade cores. Aluminium tube supports blade cores inside frame.
Fixings:	Standard - None, designed to lay into T bar ceilings. Optional - Factory fitting into Burgess tile.
Sizes:	Minimum size single unit 100mm x 50mm. Maximum size single unit 2900mm x 2900mm.
Core:	Removable with safety cord/chain under 1200mm x 1200mm neck. Non removable core over 1200mm x 1200mm neck. Removable optional.
Finish:	Standard - Mill aluminium. Stock CD4 - RAL 9010. (See website for current stock levels). Optional - Polyester powder coat to any RAL / BS colour.

Blow patterns

With one, two (opposite & corner), three and four way blow diffusers available, well considered diffuser placement can provide efficiency gains. Using a three way diffuser when placed next to a wall for example, will mean no air is directed needlessly at the wall.

Extruded aluminium only

All ceiling diffusers sold by HVC are made entirely from extruded aluminium. We do not deal with pressed diffusers.

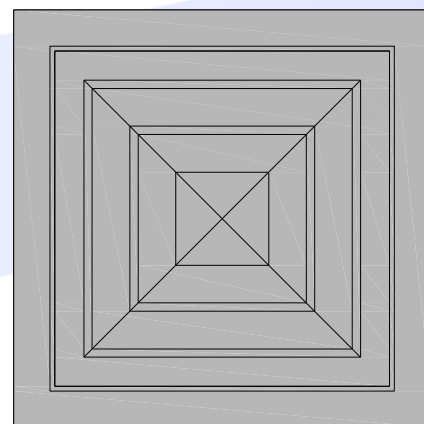

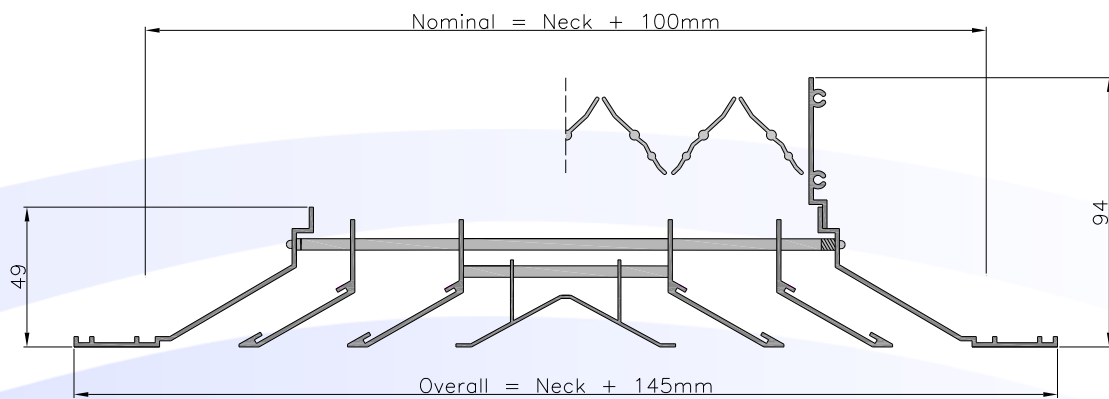
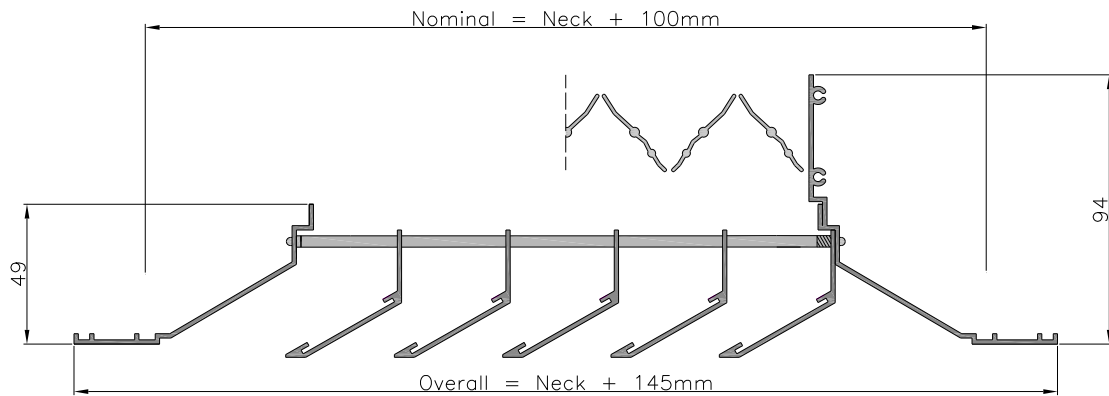

Removable cores

Standard on all units under 1200mm x 1200mm neck size, ceiling diffusers are equipped with a removable core.

All removable core CD's are fitted with a safety tie of either brass wire or chain to prevent the core being able to fall away from the ceiling entirely.

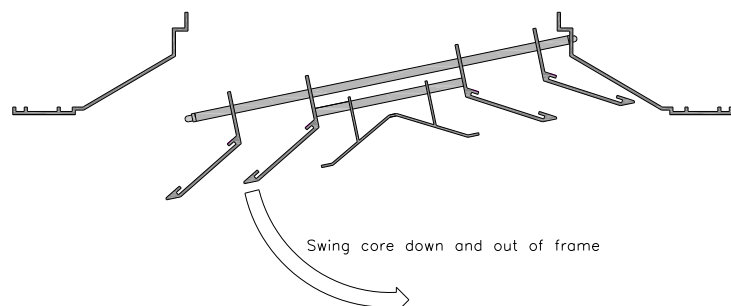
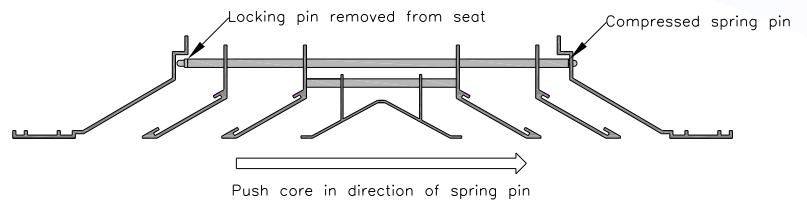

Diffusers

Ceiling (Louvre faced)

Core formats

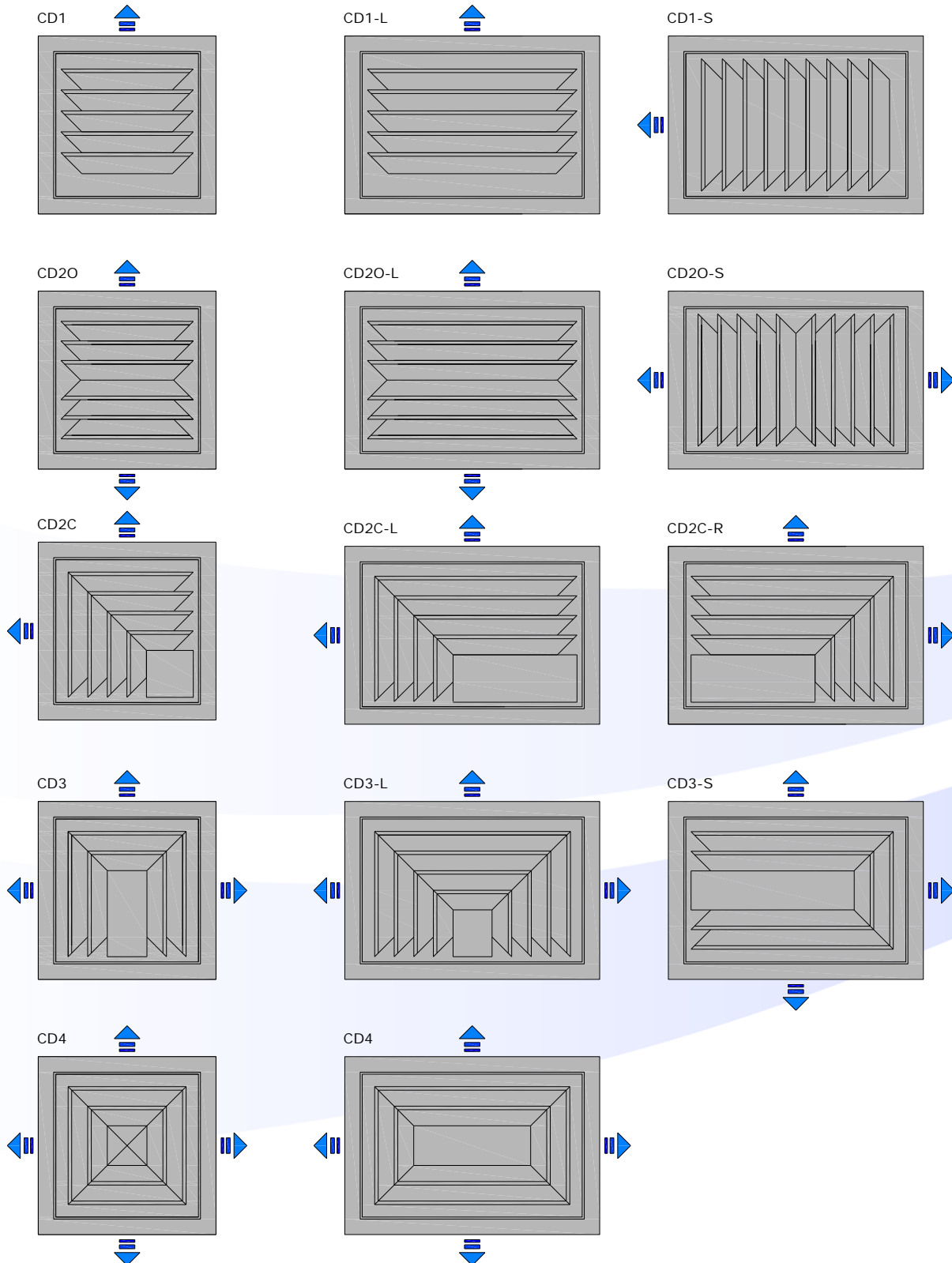

Fitting

Lay in: The method to use with using T bar ceiling systems. The diffuser is simply laid into the prepared T bar grid and connected to ductwork.

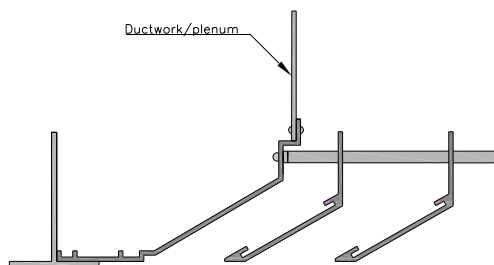

Surface mounted: The diffuser is supplied with pre-punched countersunk fixing holes and philips type screws in the same finish as the diffuser.

Fitting then simply involves screwing the diffuser into the supporting structure, and connecting it to ductwork.

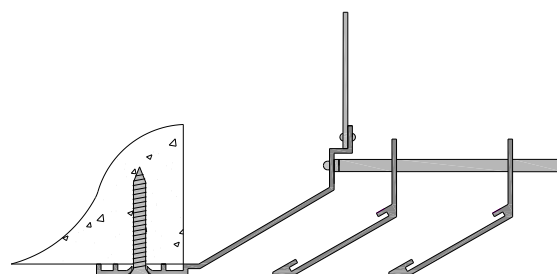

Burgess tile: The diffuser will be factory fitted into a burgess tile. Fitting then involves clipping the tile into the prepared grid and connecting the diffuser into ductwork.

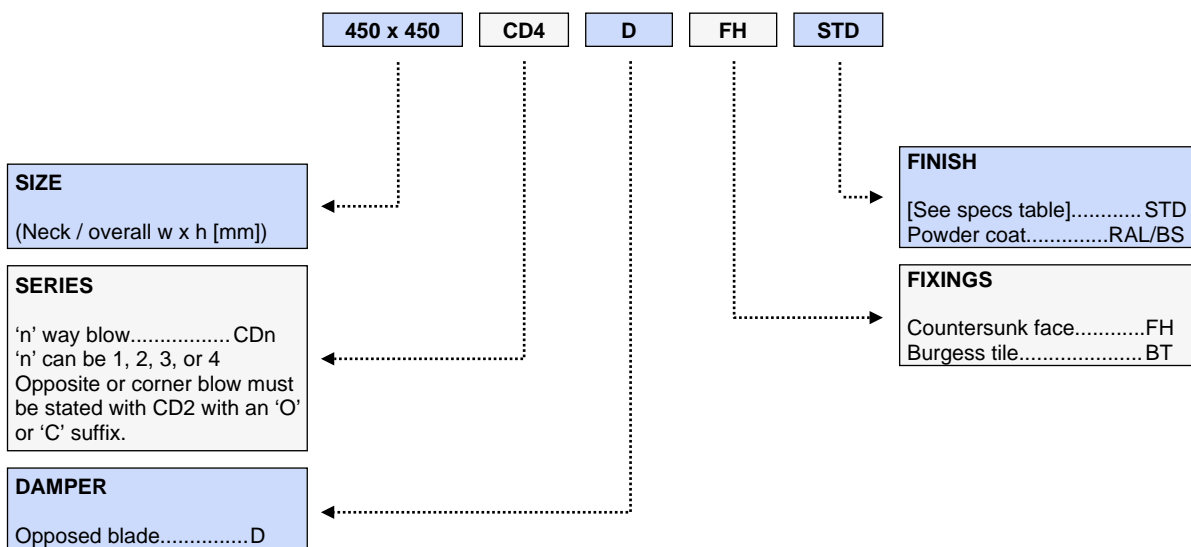
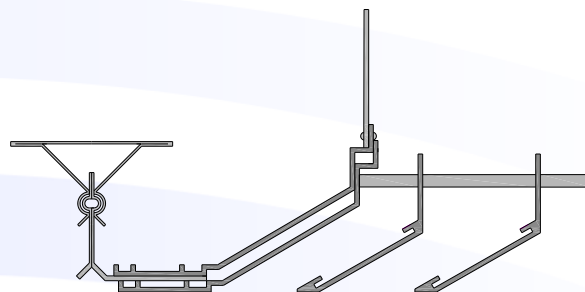

Ancillaries

Plenum boxes

Overview

Designed to facilitate the fitment of ducting to a grille or diffuser.

HVC plenum boxes are available in top or side entry models with one or multiple spigots of any diameter. Fire rated models & acoustically lined variants are also available.

Specifications:

Materials: Galvanised steel throughout

Construction: Brake press formed.

Spot welding on spigots.

Sealant used on any joints.

Fixings: Standard - Plenum riveted (or other suitable method) to grille or diffuser on site.

Optional - Fixing lugs to suit drop rod ceiling.

Flange: 12.5mm outturned flange used on everything except type CD and PPD diffusers.

Finish: Standard - Galvanised steel.

Optional - Painted to any RAL / BS colour.

The chart below gives maximum volume in m³/s that shown spigot sizes can handle for a given noise level, with neck velocities in m/s.

Spigot selection					
NC Level	25	30	35	40	45
Diameter	2.5m/s	3.0m/s	3.5m/s	4.0m/s	4.5m/s
100	0.019	0.023	0.027	0.031	0.035
125	0.03	0.037	0.043	0.049	0.055
150	0.044	0.053	0.062	0.07	0.079
160	0.05	0.06	0.07	0.08	0.09
175	0.06	0.072	0.084	0.096	0.108
200	0.078	0.094	0.11	0.125	0.14
225	0.1	0.12	0.14	0.16	0.18
250	0.12	0.147	0.17	0.196	0.22
300	0.177	0.212	0.247	0.28	0.32
315	0.195	0.23	0.27	0.31	0.35
350	0.24	0.29	0.33	0.38	0.43
400	0.31	0.38	0.44	0.5	0.56
450	0.4	0.48	0.56	0.64	0.72
500	0.49	0.59	0.68	0.78	0.88
550	0.59	0.71	0.83	0.95	1.07
600	0.7	0.85	0.99	1.13	1.27

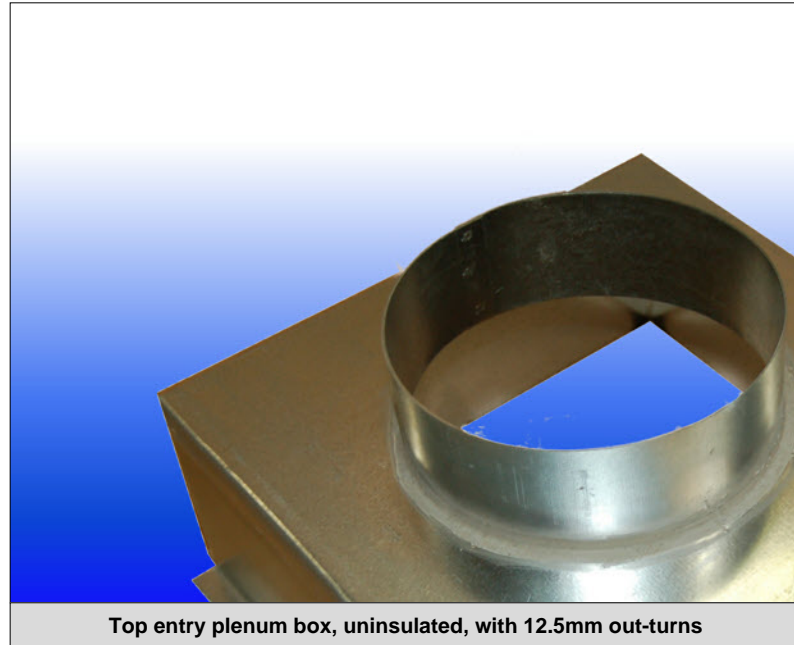

Top entry: Series TEPB

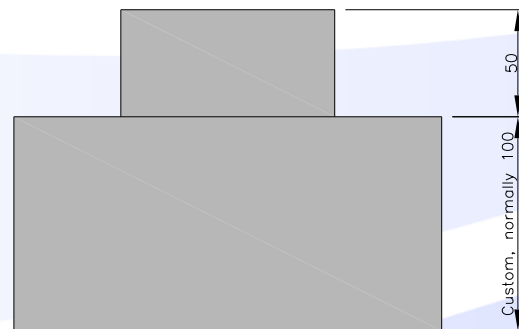

Side entry: Series SEPB

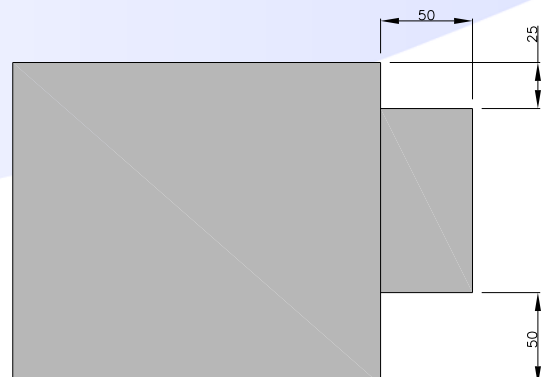

TEPB / SEPB / FRTEPB / FRSEPB

Fire rated: Series FRTEPB / FRSEPB

Constructed from fully welded 1.22mm thick galvanised steel, and with an integrated S200 fire damper rated for a period of six hours, or an intumescent damper rated at one hour.

The spring loaded damper blades of S200 fire dampers also mean that top entry boxes can be made fire rated, as well as side entry.

HVC always recommend consulting the relevant fire authority when installing fire rated HVAC equipment.

Side entry: Series FRSEPB

Top entry: Series FRTEPB

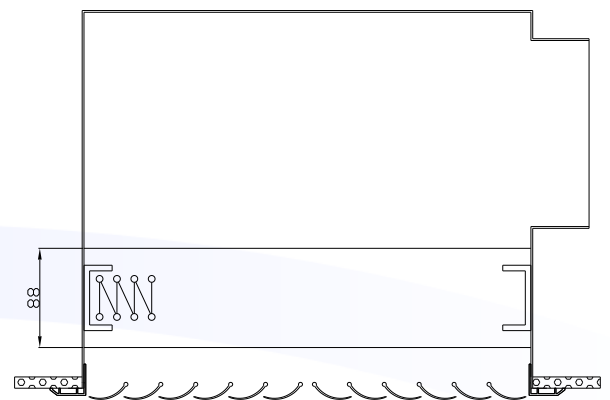
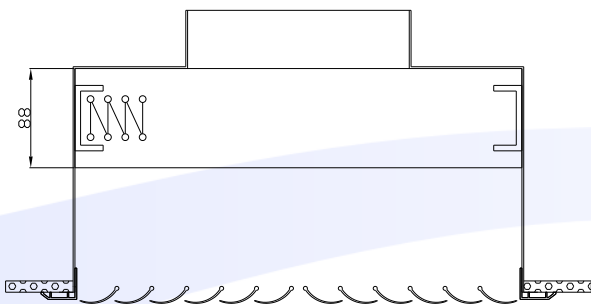

600 x 600 SEPB 2C 200 F SBD IN-RAL9005

SIZE
(Nominal / overall w x h [mm])

SERIES

SPIGOT ARRANGEMENT
State number reqd 'n'.....'n'
Double spigot opposite...2OP
Double spigot corner..... 2C

SPIGOT SIZE
000.....∅
000 x 000..... W x H

FURTHER OPTIONS
Painted interior..... IN-RAL__
Painted exterior..... EX-RAL__
Insulated interior....IN-INS
Insulated exterior...EX-INS

SPIGOT DAMPER
Single blade damper fitted to all spigots.....SBD

FLANGE
12.5mm all round
If different required state size

BOX DEPTH
Not needed if Series = SEPB

Selection data

CD1 / CD1-S

Minimum and maximum throws based on jet terminal velocities of 0.25m/s and 0.75m/s respectively.

CD1							
SIZE(w x h)	AK m sq.	NECK VELOCITY m/s	1.5	2	2.5	3	3.5
		Total Pd mm w.g.	0.9	1.5	2.3	3.3	4.3
150 x 150	0.0097	m cub/sec	0.0361	0.0472	0.0597	0.0708	0.0833
		Throw min-max (m)	0.9 - 2.4	1.2 - 2.8	1.5 - 3.0	2.2 - 3.4	2.5 - 3.7
		Noise (dB)			20	24	28
225 x 225	0.0219	m cub/sec	0.0805	0.1069	0.1319	0.1611	0.1861
		Throw min-max (m)	1.5 - 3.7	2.1 - 4.3	2.4 - 4.6	3.1 - 5.2	3.7 - 5.5
		Noise (dB)		20	25	29	32
300 x 300	0.039	m cub/sec	0.1416	0.1888	0.2361	0.2833	0.3305
		Throw min-max (m)	2.2 - 4.9	2.8 - 5.5	3.4 - 6.4	4.0 - 6.7	4.6 - 7.3
		Noise (dB)		23	28	32	35
375 x 375	0.0609	m cub/sec	0.2222	0.2958	0.368	0.4444	0.5166
		Throw min-max (m)	2.5 - 6.1	3.4 - 7.0	4.3 - 8.0	4.9 - 8.6	5.8 - 9.2
		Noise (dB)		25	30	34	37

CD1-S							
SIZE(w x h)	AK m sq.	NECK VELOCITY m/s	1.5	2	2.5	3	3.5
		Total Pd mm w.g.	0.9	1.5	2.3	3.3	4.3
225 x 150	0.0147	m cub./sec.	0.0541	0.0708	0.0902	0.1069	0.125
		Throw min-max (m)	1.8 - 4.3	2.4 - 4.9	3.0 - 5.5	3.3 - 5.8	3.9 - 6.4
		Noise (dB)			23	27	30
300 x 225	0.0292	m cub./sec.	0.1083	0.1416	0.1791	0.2125	0.25
		Throw min-max (m)	2.4 - 5.8	3.3 - 6.7	3.9 - 7.6	4.9 - 8.6	5.8 - 9.2
		Noise (dB)		22	27	30	34
375 x 300	0.0487	m cub/sec	0.1777	0.2361	0.2958	0.3541	0.4138
		Throw min-max (m)	3.1 - 7.6	4.3 - 8.8	5.2 - 9.8	6.4 - 10.9	7.3 - 11.6
		Noise (dB)		24	29	33	36

Selection data

CD1-L

CD1-L							
SIZE(w x h)	AK m sq.	NECK VELOCITY m/s	1.5	2	2.5	3	3.5
		Total Pd mm wg	0.9	1.5	2.3	3.3	4.3
225 x 150	0.0147	m cub/sec	0.0541	0.0708	0.0902	0.1069	0.125
		Throw min-max (m)	1.8 - 4.3	2.4 - 4.9	3.0 - 5.5	3.3 - 5.8	4.0 - 6.4
		Noise (dB)			23	27	30
300 x 150	0.0195	m cub/sec	0.0708	0.0944	0.118	0.1416	0.1652
		Throw min-max (m)	2.2 - 4.9	2.8 - 5.5	3.4 - 6.4	4.0 - 6.7	4.6 - 7.3
		Noise (dB)			24	28	32
375 x 150	0.0244	m cub/sec	0.0902	0.118	0.1486	0.1777	0.2083
		Throw min-max (m)	2.2 - 5.5	3.0 - 6.4	3.7 - 7.0	4.6 - 7.6	5.2 - 8.3
		Noise (dB)		20	26	29	33
450 x 150	0.0292	m cub/sec	0.1083	0.1416	0.1791	0.2125	0.25
		Throw min-max (m)	2.5 - 5.8	3.4 - 6.7	4.0 - 7.6	4.9 - 8.6	5.8 - 9.2
		Noise (dB)		22	27	30	34
300 x 225	0.0292	m cub/sec	0.1083	0.1416	0.1791	0.2125	0.25
		Throw min-max (m)	2.5 - 5.8	3.4 - 6.7	4.0 - 7.6	4.9 - 8.6	5.8 - 9.2
		Noise (dB)		22	27	30	34
375 x 225	0.0367	m cub/sec	0.1319	0.1763	0.2222	0.2666	0.3125
		Throw min-max (m)	2.8 - 6.7	3.7 - 7.6	4.6 - 8.6	5.5 - 9.5	6.4 - 10.0
		Noise (dB)		22	27	32	35
525 x 225	0.0511	m cub/sec	0.1861	0.2486	0.3097	0.3708	0.4319
		Throw min-max (m)	3.4 - 8.0	4.3 - 9.2	5.5 - 10.0	6.4 - 11.0	7.7 - 11.9
		Noise (dB)		24	29	33	37
375 x 300	0.0487	m cub/sec	0.1777	0.2361	0.2958	0.3541	0.4138
		Throw min-max (m)	3.1 - 7.6	4.3 - 8.9	5.2 - 9.8	6.4 - 11.0	7.3 - 11.6
		Noise (dB)		24	29	33	36
450 x 300	0.0585	m cub/sec	0.2125	0.2833	0.3541	0.425	0.4958
		Throw min-max (m)	3.4 - 8.6	4.6 - 9.8	5.8 - 11.0	7.1 - 11.9	8.0 - 12.8
		Noise (dB)		25	30	33	37
525 x 300	0.0683	m cub/sec	0.2486	0.3305	0.4138	0.4958	0.5791
		Throw min-max (m)	3.7 - 9.2	4.9 - 10.4	6.1 - 11.6	7.4 - 12.8	8.9 - 13.7
		Noise (dB)	20	26	30	34	37

Selection data

CD20 / CD20-S

Minimum and maximum throws based on jet terminal velocities of 0.25m/s and 0.75m/s respectively.

CD20							
SIZE	AK m sq.	NECK VELOCITYm/s	1.5	2	2.5	3	3.5
		Total Pd mm wg	0.9	1.5	2.3	3.3	4.3
150 x 150	0.0097	m cub/sec	0.0361	0.0472	0.0597	0.0708	0.0833
		Throw min-max (m)	0.9 - 2.4	1.2 - 2.8	1.5 - 3.0	2.2 - 3.4	2.5 - 3.7
		Noise (dB)			20	24	28
225 x 225	0.0219	m cub/sec	0.0805	0.1069	0.1319	0.1611	0.1861
		Throw min-max (m)	1.5 - 3.7	2.1 - 4.3	2.4 - 4.6	3.1 - 5.2	3.7 - 5.5
		Noise (dB)		20	25	29	32
300 x 300	0.039	m cub/sec	0.1416	0.1888	0.2361	0.2833	0.3305
		Throw min-max (m)	2.2 - 4.9	2.8 - 5.5	3.4 - 6.4	4.0 - 6.7	4.6 - 7.3
		Noise (dB)		23	28	32	35
375 x 375	0.0609	m cub/sec	0.2222	0.2958	0.368	0.4444	0.5166
		Throw min-max (m)	2.5 - 6.1	3.4 - 7.0	4.3 - 8.0	4.9 - 8.6	5.8 - 9.2
		Noise (dB)		25	30	34	37
450 x 450	0.0878	m cub./sec.	0.3194	0.425	0.5319	0.6375	0.7444
		Throw min-max (m)	3.1 - 7.3	4.0 - 8.6	4.9 - 9.5	6.1	7.1 - 11.0
		Noise (dB)	21	27	32	35	39
525 x 525	0.12	m cub./sec.	0.4347	0.5791	0.7222	0.8694	1.0138
		Throw min-max (m)	3.4 - 8.6	4.6 - 9.8	5.8 - 11.0	7.1 - 11.9	8.3 - 12.8
		Noise (dB)	22	28	34	37	41

CD20-S							
SIZE	AK m sq.	NECK VELOCITYm/s	1.5	2	2.5	3	3.5
		Total Pd mm wg	0.9	1.5	2.3	3.3	4.3
225 x 150	0.0097	m cub/sec	0.0361	0.0472	0.0597	0.0708	0.0833
		Throw min-max (m)	0.9 - 2.4	1.2 - 2.8	1.5 - 3.0	2.2 - 3.4	2.5 - 3.7
		Noise (dB)			20	24	28
300 x 150	0.0195	m cub/sec	0.0708	0.0944	0.118	0.1416	0.1652
		Throw min-max (m)	1.5 - 4.3	1.8 - 4.0	2.4 - 4.3	2.7 - 4.9	3.3 - 5.2
		Noise (dB)			24	28	32
300 x 225	0.0292	m cub/sec	0.1083	0.1416	0.1791	0.2125	0.25
		Throw min-max (m)	1.8 - 4.3	2.4 - 4.9	3.0 - 5.5	3.3 - 5.8	3.9 - 6.4
		Noise (dB)		22	27	30	34
375 x 225	0.0367	m cub/sec	0.1319	0.1777	0.2222	0.2666	0.3125
		Throw min-max (m)	1.8 - 4.6	2.4 - 5.5	3.3 - 6.1	3.9 - 6.7	4.5 - 7.3
		Noise (dB)		22	27	32	35
375 x 300	0.0487	m cub./sec.	0.1777	0.2361	0.2958	0.3541	0.4138
		Throw min-max (m)	2.8 - 5.5	3.2 - 6.4	4.0 - 7.0	4.6 - 8.0	5.2 - 8.6
		Noise (dB)		24	29	33	36

Selection data

CD20-L

CD20-L							
SIZE	AK m sq.	NECK VELOCITY m/s	1.5	2	2.5	3	3.5
		Total Pd mm wg	0.9	1.5	2.3	3.3	4.3
225 x 150	0.0147	m cub/sec	0.0541	0.0708	0.0902	0.1069	0.125
		Throw min-max (m)	1.2 - 3.1	1.5 - 3.4	2.1 - 4.0	2.4 - 4.2	2.7 - 4.6
		Noise (dB)			23	27	30
300 x 150	0.0195	m cub/sec	0.0708	0.0944	0.118	0.1416	0.1652
		Throw min-max (m)	1.5 - 3.4	1.8 - 4.0	2.4 - 4.3	2.7 - 4.9	3.3 - 5.2
		Noise (dB)			24	28	32
375 x 150	0.0244	m cub/sec	0.0902	0.118	0.1486	0.1777	0.2083
		Throw min-max (m)	1.5 - 4.3	2.1 - 4.9	2.7 - 5.2	3.0 - 5.8	3.6 - 6.4
		Noise (dB)		20	26	29	33
450 x 150	0.0292	m cub/sec	0.1083	0.1416	0.1791	0.2125	0.25
		Throw min-max (m)	1.8 - 4.3	2.4 - 4.9	3.0 - 5.5	3.3 - 5.8	4.0 - 6.4
		Noise (dB)		22	27	30	34
300 x 225	0.0292	m cub./sec.	0.1083	0.1416	0.1791	0.2125	0.25
		Throw min-max (m)	1.8 - 4.3	2.4 - 4.9	3.0 - 5.5	3.3 - 5.8	4.0 - 6.4
		Noise (dB)		22	27	30	34
375 x 225	0.0367	m cub./sec.	0.1319	0.1763	0.2222	0.2666	0.3125
		Throw min-max (m)	1.8 - 4.6	2.4 - 5.5	3.4 - 6.1	4.0 - 6.7	4.6 - 7.4
		Noise (dB)		22	27	32	35
525 x 225	0.0511	m cub./sec.	0.1861	0.2486	0.3097	0.3708	0.4319
		Throw min-max (m)	2.8 - 5.5	3.1 - 6.4	4.0 - 7.0	4.6 - 8.0	5.2 - 8.6
		Noise (dB)		24	29	33	37
375 x 300	0.0487	m cub./sec.	0.1777	0.2361	0.2958	0.3541	0.4138
		Throw min-max (m)	2.8 - 5.5	3.1 - 6.4	4.0 - 7.0	4.6 - 8.0	5.2 - 8.6
		Noise (dB)		24	29	33	36
450 x 300	0.0585	m cub./sec.	0.2125	0.2833	0.3541	0.425	0.4958
		Throw min-max (m)	2.5 - 5.8	3.4 - 6.7	4.0 - 7.6	4.9 - 8.6	5.8 - 9.2
		Noise (dB)		25	30	33	37
525 x 300	0.0683	m cub./sec.	0.2486	0.3305	0.4138	0.4958	0.5791
		Throw min-max (m)	2.7 - 6.4	3.7 - 7.3	4.3 - 8.3	5.2 - 9.2	6.1 - 9.8
		Noise (dB)	20	26	30	34	37
450 x 375	0.0732	m cub./sec.	0.2666	0.3451	0.4444	0.5336	0.6208
		Throw min-max (m)	2.8 - 6.7	3.7 - 7.7	4.6 - 8.6	5.5 - 9.5	6.4 - 10.1
		Noise (dB)	20	26	31	35	38

Selection data

CD2C

Minimum and maximum throws based on jet terminal velocities of 0.25m/s and 0.75m/s respectively.

CD2C							
SIZE	AK m sq.	NECK VELOCITY m/s	1.5	2	2.5	3	3.5
		Total Pd mm wg	0.9	1.5	2.3	3.3	4.3
150 x 150	0.0097	m cub/sec	0.0361	0.0472	0.0597	0.0708	0.0833
		Throw min-max (m)	0.9 - 2.5	1.2 - 2.8	1.6 - 3.0	2.2 - 3.4	2.5 - 3.7
		Noise (dB)			20	24	28
225 x 225	0.0219	m cub/sec	0.0805	0.1069	0.1319	0.1611	0.1875
		Throw min-max (m)	1.6 - 3.7	2.2 - 4.3	2.5 - 4.6	3.0 - 5.2	3.4 - 5.5
		Noise (dB)		20	25	29	32
300 x 300	0.039	m cub/sec	0.1416	0.1888	0.2361	0.2833	0.3305
		Throw min-max (m)	2.2 - 4.9	2.8 - 5.5	3.4 - 6.4	4.0 - 6.7	4.6 - 7.4
		Noise (dB)		23	28	32	35
375 x 375	0.0609	m cub/sec	0.2222	0.2958	0.3694	0.4444	0.518
		Throw min-max (m)	2.5 - 6.1	3.4 - 7.1	4.3 - 8.0	4.9 - 8.6	5.8 - 9.2
		Noise (dB)		25	30	34	37
450 x 450	0.0878	m cub./sec.	0.3194	0.425	0.5319	0.6375	0.7444
		Throw min-max (m)	3.1 - 7.4	4.0 - 8.6	4.9 - 9.5	6.1 - 10.4	7.1 - 11.0
		Noise (dB)	21	27	32	35	39

Selection data

CD2C-L / CD2C-R

CD2C-L / CD2C-R							
SIZE	AK m sq.	NECK VELOCITY m/s	1.5	2	2.5	3	3.5
		Total Pd mm wg	0.9	1.5	2.3	3.3	4.3
225 x 150	0.0147	m cub./sec.	0.0541	0.0708	0.0902	0.1069	0.125
		Throw min-max (m) Shorter side	0.9 - 2.5	1.3 - 2.8	1.9 - 3.1	2.2 - 3.4	2.5 - 3.7
		Throw min-max (m) Longer side	1.6 - 3.4	1.9 - 4.0	2.5 - 4.3	2.8 - 4.9	3.4
		Noise (dB)			23	27	30
300 x 150	0.0195	m cub./sec.	0.0708	0.0944	0.118	0.1416	0.1652
		Throw min-max (m) Shorter side	0.9 - 2.5	1.3 - 2.8	1.9 - 3.1	2.2 - 3.4	2.5 - 3.7
		Throw min-max (m) Longer side	1.9 - 4.3	2.5 - 4.9	2.8 - 5.5	3.4 - 5.8	4.0 - 6.4
		Noise (dB)			24	28	32
375 x 150	0.0244	m cub./sec.	0.0902	0.118	0.1486	0.1777	0.2083
		Throw min-max (m) Shorter side	0.9 - 2.5	1.3 - 2.8	1.9 - 3.1	2.2 - 3.4	2.5 - 3.7
		Throw min-max (m) Longer side	2.2 - 4.9	2.8 - 5.5	3.4 - 6.4	4.0 - 6.7	4.6 - 7.4
		Noise (dB)		20	26	29	33
300 x 225	0.0292	m cub./sec.	0.1083	0.1416	0.1791	0.2125	0.25
		Throw min-max (m) Shorter side	1.6 - 3.7	1.9 - 4.3	2.5 - 4.6	3.1 - 5.2	3.4 - 5.5
		Throw min-max (m) Longer side	2.2 - 4.6	2.8 - 5.5	3.4 - 6.1	4.0 - 6.7	4.6 - 7.3
		Noise (dB)		22	27	30	34
375 x 225	0.0367	m cub./sec.	0.1319	0.1777	0.2222	0.2666	0.3125
		Throw min-max (m) Shorter side	1.6 - 3.7	1.9 - 4.3	2.5 - 4.6	3.1 - 5.2	3.4 - 5.5
		Throw min-max (m) Longer side	2.2 - 5.5	3.1 - 6.4	3.7 - 7.0	4.6 - 8.0	5.5 - 8.6
		Noise (dB)		22	27	32	35
375 x 300	0.0487	m cub./sec.	0.1777	0.2361	0.2958	0.3541	0.4138
		Throw min-max (m) Shorter side	2.2 - 4.9	2.8 - 5.5	3.4 - 6.4	4.0 - 6.7	4.6 - 7.4
		Throw min-max (m) Longer side	2.5 - 5.8	3.4 - 6.7	4.0 - 7.6	4.9 - 8.6	5.8 - 9.2
		Noise (dB)		24	29	33	36
450 x 300	0.0585	m cub./sec.	0.2125	0.2833	0.3541	0.425	0.4958
		Throw min-max (m) Shorter side	2.2 - 4.9	2.8 - 5.5	3.4 - 6.4	4.0 - 6.7	4.6 - 7.3
		Throw min-max (m) Longer side	2.8 - 6.7	3.7 - 8.0	4.6 - 8.9	5.8 - 9.8	6.7 - 10.4
		Noise (dB)		25	30	33	37
450 x 375	0.0732	m cub./sec.	0.2666	0.3451	0.4444	0.5333	0.6208
		Throw min-max (m) Shorter side	2.5 - 6.1	3.4 - 7.0	4.3 - 8.0	4.9 - 8.6	5.8 - 9.2
		Throw min-max (m) Longer side	3.1 - 7.0	4.0 - 8.3	4.9 - 9.2	5.8 - 10.1	7.0 - 11.0
		Noise (dB)	20	26	31	35	38

Selection data

CD3 / CD3-S

Minimum and maximum throws based on jet terminal velocities of 0.25m/s and 0.75m/s respectively.

CD3							
SIZE	AK m sq.	NECK VELOCITY m/s	1.5	2	2.5	3	3.5
		Total Pd mm wg	0.9	1.5	2.3	3.3	4.3
150 x 150	0.0097	m cub/sec	0.0361	0.0472	0.0597	0.0708	0.0833
		Throw min-max (m)	0.7 - 1.6	0.9 - 1.9	1.3 - 2.2	1.6 - 2.5	1.6 - 2.8
		Noise (dB)					19
225 x 225	0.0219	m cub/sec	0.0805	0.1069	0.1319	0.1611	0.1861
		Throw min-max (m)	1.3 - 2.5	1.6 - 3.1	1.9 - 3.4	2.2 - 3.7	2.5 - 4.0
		Noise (dB)				23	27
300 x 300	0.039	m cub/sec	0.1416	0.1888	0.2361	0.2833	0.3305
		Throw min-max (m)	1.6 - 3.4	1.9 - 4.0	2.5 - 4.3	2.9 - 4.9	3.4 - 5.2
		Noise (dB)		20	25	29	32
375 x 375	0.0609	m cub/sec	0.2222	0.2958	0.368	0.4444	0.5166
		Throw min-max (m)	1.9 - 4.3	2.2 - 4.9	3.1 - 5.5	3.7 - 6.1	4.3 - 6.4
		Noise (dB)		24	29	33	37
450 x 450	0.0878	m cub./sec.	0.3194	0.425	0.5319	0.6375	0.7444
		Throw min-max (m)	2.2 - 5.2	2.8 - 5.8	3.7 - 6.7	4.3 - 7.4	4.9 - 8.0
		Noise (dB)	22	28	33	36	40
525 x 525	0.12	m cub./sec.	0.4347	0.5791	0.7222	0.8694	1.0138
		Throw min-max (m)	2.5 - 6.1	3.4 - 7.1	4.3 - 7.7	4.9 - 8.6	5.8 - 9.2
		Noise (dB)	25	31	36	39	43
600 x 600	0.156	m cub./sec.	0.5666	0.7555	0.9444	11.333	13.222
		Throw min-max (m)	2.8 - .7	4.0 - 8.0	4.6 - 4.9	5.8 - 9.8	6.7 - 10.4
		Noise (dB)	27	33	38	43	46

CD3-S							
SIZE	AK m sq.	NECK VELOCITY m/s	1.5	2	2.5	3	3.5
		Total Pd mm wg	0.9	1.5	2.3	3.3	4.3
225 x 150	0.0147	m cub/sec	0.0541	0.0708	0.0902	0.1069	0.125
		Throw min-max (m) -Front	1.2 - 2.5	1.9 - 4.0	1.9 - 3.4	2.2 - 3.7	3.4 - 5.2
		Throw min-max (m) -Sides	0.9 - 2.5	1.3 - 2.8	1.6 - 3.1	1.9 - 3.4	2.2 - 3.7
		Noise (dB)			23	27	30
300 x 150	0.0195	m cub/sec	0.0708	0.0944	0.118	0.1416	0.1652
		Throw min-max (m) -Front	1.6 - 6.4	1.9 - 4.0	2.5 - 4.3	2.8 - 4.9	3.4 - 5.2
		Throw min-max (H6m) -Sides	0.9 - 2.5	1.3 - 2.8	1.6 - 3.1	1.9 - 3.4	2.2 - 3.7
		Noise (dB)			24	28	32
375 x 150	0.0244	m cub/sec	0.0902	0.118	0.1486	0.1777	0.2083
		Throw min-max (m) -Front	1.9 - 4.3	2.5 - 4.9	3.1 - 5.5	3.4 - 5.8	4.0 - 6.4
		Throw min-max (m) -Sides	0.9 - 2.5	1.3 - 2.8	1.9 - 3.1	1.9 - 3.4	2.2 - 3.7
		Noise (dB)		20	26	29	33

Selection data

CD3-S

CD3-S							
SIZE	AK m sq.	NECK VELOCITY m/s	1.5	2	2.5	3	3.5
		Total Pd mm wg	0.9	1.5	2.3	3.3	4.3
450 x 150	0.0292	m cub/sec	0.1083	0.1416	0.1791	0.2125	0.25
		Throw min-max (m) -Front	2.2 - 4.9	2.8 - 5.5	3.4 - 6.4	4.0 - 6.7	4.6 - 7.3
		Throw min-max (m) -Sides	0.9 - 2.5	1.3 - 2.8	1.9 - 3.1	1.9 - 3.4	2.2 - 3.7
		Noise (dB)		22	27	30	34
300 x 225	0.0292	m cub/sec	0.1083	0.1416	0.1791	0.2125	0.25
		Throw min-max (m) -Front	16 - 3.4	1.9 - 4.0	2.5 - 4.3	2.8 - 4.9	3.4 - 5.2
		Throw min-max (m) -Sides	1.6 - 3.4	1.9 - 4.0	2.5 - 4.3	2.8 - 4.9	3.4 - 5.2
		Noise (dB)		22	27	30	34
375 x 225	0.0367	m cub/sec	0.1319	0.1777	0.2222	0.2666	0.3125
		Throw min-max (m) -Front	1.9 - 4.3	2.5 - 4.9	3.1 - 5.5	3.7 - 6.1	4.3 - 6.4
		Throw min-max (m) -Sides	1.6 - 3.7	1.9 - 4.3	2.5 - 4.6	3.1 - 5.2	3.4 - 5.5
		Noise (dB)		22	27	32	35
525 x 225	0.0511	m cub/sec	0.1861	0.2486	0.3097	0.3708	0.4319
		Throw min-max (m) -Front	2.5 - 5.8	3.4 - 6.7	4.0 - 7.7	4.9 - 8.6	5.8 - 6.1
		Throw min-max (m) -Sides	1.6 - 3.7	2.2 - 4.3	2.5 - 4.6	3.1 - 5.2	3.4 - 5.5
		Noise (dB)		24	29	33	37
375 x 300	0.0487	m cub/sec	0.1777	0.2361	0.2958	0.3541	0.4138
		Throw min-max (m) -Front	1.9 - 4.3	2.5 - 4.9	3.1 - 5.5	3.7 - 6.1	4.3 - 6.4
		Throw min-max (m) -Sides	1.9 - 3.4	2.5 - 4.0	3.1 - 4.6	3.7 - 4.9	4.3 - 5.2
		Noise (dB)		24	29	33	36
450 x 300	0.0585	m cub/sec	0.2125	0.2833	0.3541	0.425	0.4958
		Throw min-max (m) -Front	2.2 - 5.2	2.8 - 5.8	3.7 - 6.7	4.3 - 7.3	4.9 - 8.0
		Throw min-max (m) -Sides	1.9 - 4.6	2.5 - 5.5	3.4 - 6.1	4.0 - 6.7	4.6 - 7.4
		Noise (dB)		25	30	33	37
450 x 375	0.0732	m cub/sec	0.2666	0.3541	0.4444	0.5333	0.6208
		Throw min-max (m) -Front	2.5 - 5.5	3.1 - 6.4	4.0 - 7.1	4.6 - 8.0	5.5 - 8.6
		Throw min-max (m) -Sides	2.2 - 5.2	2.8 - 5.8	3.7 - 6.7	4.3 - 7.3	4.9 - 8.0
		Noise (dB)	20	26	31	35	38
525 x 450	0.102	m cub/sec	0.3736	0.4958	0.6208	0.7458	0.8694
		Throw min-max (m) -Front	2.8 - 6.7	3.7 - 7.7	4.6 - 8.6	5.5 - 9.5	6.4 - 10.1
		Throw min-max (m) -Sides	2.5 - 6.1	3.4 - 7.1	4.3 - 7.7	4.9 - 8.6	5.8 - 9.2
		Noise (dB)	22	28	34	37	40

Selection data

CD3-L

Minimum and maximum throws based on jet terminal velocities of 0.25m/s and 0.75m/s respectively.

CD3 - Long side blades							
SIZE	AK m sq.	NECK VELOCITY m/s	1.5	2	2.5	3	3.5
		Total Pd mm wg	0.9	1.5	2.3	3.3	4.3
225 x 150	0.0147	m cub/sec	0.0541	0.0708	0.0902	0.1069	0.125
		Throw min-max (m) -Front	0.7 - 1.9	0.9 - 1.9	1.9 - 3.4	2.2 - 4.0	2.8 - 4.3
		Throw min-max (m) -Sides	1.3 - 2.8	1.6 - 3.1	1.9 - 3.4	2.2 - 4.0	2.8 - 4.3
		Noise (dB)			23	27	30
300 x 150	0.0195	m cub/sec	0.0708	0.0944	0.118	0.1486	0.1652
		Throw min-max (m) -Front	0.7 - 1.9	0.9 - 1.9	1.3 - 2.2	1.6 - 2.5	1.6 - 2.8
		Throw min-max (m) -Sides	1.3 - 3.4	1.9 - 3.7	2.2 - 4.3	2.8 - 4.6	3.2 - 4.9
		Noise (dB)			24	28	32
375 x 150	0.0244	m cub/sec	0.0902	0.118	0.1486	0.1777	0.2083
		Throw min-max (m) -Front	0.6 - 1.9	0.9 - 1.9	1.3 - 2.2	1.6 - 2.5	1.6 - 2.8
		Throw min-max (m) -Sides	1.6 - 3.7	2.2 - 4.3	2.5 - 4.6	3.1 - 5.2	3.7 - 5.5
		Noise (dB)		20	26	29	33
300 x 225	0.0292	m cub/sec	0.1083	0.1416	0.1791	0.2125	0.25
		Throw min-max (m) -Front	0.9 - 2.5	1.6 - 3.1	1.9 - 3.4	2.2 - 3.7	2.5 - 4.0
		Throw min-max (m) -Sides	1.6 - 3.7	2.2 - 4.3	2.8 - 4.9	3.1 - 5.5	3.7 - 5.8
		Noise (dB)		22	27	30	34
375 x 225	0.0367	m cub/sec	0.1319	0.1777	0.2222	0.2666	0.3125
		Throw min-max (m) -Front	0.9 - 2.5	1.6 - 3.1	1.9 - 3.4	2.2 - 3.7	
		Throw min-max (m) -Sides	1.9 - 4.3	2.5 - 4.9	3.1 - 5.5	3.6 - 6.1	4.3 - 6.7
		Noise (dB)		22	27	32	35
525 x 225	0.0511	m cub/sec	0.1861	0.2486	0.3097	0.3708	0.4319
		Throw min-max (m) -Front	1.3 - 2.5	1.6 - 3.1	1.9 - 3.4	2.3 - 3.7	2.5 - 4.0
		Throw min-max (m) -Sides	2.2 - 5.2	2.8 - 6.1	3.7 - 6.7	4.3 - 7.4	5.2 - 8.0
		Noise (dB)		24	29	33	37
375 x 300	0.0487	m cub/sec	0.1777	0.2361	0.2958	0.3541	0.4138
		Throw min-max (m) -Front	1.6 - 3.4	1.9 - 4.0	2.5 - 4.3	2.8 - 4.9	3.4 - 5.2
		Throw min-max (m) -Sides	2.2 - 4.9	2.8 - 5.8	3.4 - 6.4	4.0 - 6.7	4.6 - 7.4
		Noise (dB)					
450 x 300	0.0585	m cub/sec	0.2125	0.2833	0.3541	0.425	0.4958
		Throw min-max (m) -Front	1.6 - 3.4	1.9 - 4.0	2.5 - 4.3	2.8 - 4.9	3.4 - 5.2
		Throw min-max (m) -Sides	2.2 - 5.5	3.1 - 6.4	3.7 - 7.1	4.6 - 8.0	5.2 - 8.3
		Noise (dB)		25	30	33	37
450 x 375	0.0732	m cub/sec	0.2666	0.3541	0.4444	0.5333	0.6208
		Throw min-max (m) -Front	1.9 - 4.3	2.5 - 4.9	3.1 - 5.5	3.7 - 6.1	4.3 - 6.4
		Throw min-max (m) -Sides	2.5 - 5.8	3.4 - 6.7	4.0 - 7.7	4.9 - 8.3	5.8 - 9.2
		Noise (dB)	20	26	31	35	38
525 x 450	0.102	m cub/sec	0.3736	0.4958	0.6208	0.7458	0.8694
		Throw min-max (m) -Front	2.2 - 5.2	2.8 - 5.8	3.7 - 6.7	4.3 - 7.4	4.9 - 8.0
		Throw min-max (m) -Sides	2.8 - 7.1	4.0 - 8.0	4.9 - 8.9	5.8 - 9.8	6.7 - 10.7
		Noise (dB)	22	28	32	37	40

CD4 - Square sizes							
SIZE	AK m sq.	NECK VELOCITY m/s	1.5	2	2.5	3	3.5
		Total Pd mm wg	0.9	1.5	2.3	3.3	4.3
150 x 150	0.0097	m cub/sec	0.0361	0.0472	0.0597	0.0708	0.0833
		Throw min-max (m)	0.7 - 1.6	0.9 - 1.9	1.3 - 2.2	1.6 - 2.5	1.6 - 2.8
		Noise (dB)					19
225 x 225	0.0219	m cub/sec	0.0805	0.1069	0.1319	0.1611	0.1861
		Throw min-max (m)	1.3 - 2.5	1.6 - 3.1	1.9 - 3.4	2.2 - 3.7	2.5 - 4.0
		Noise (dB)				23	27
300 x 300	0.039	m cub/sec	0.1416	0.1888	0.2361	0.2833	0.3305
		Throw min-max (m)	1.6 - 3.4	1.9 - 4.0	2.5 - 4.3	2.9 - 4.9	3.4 - 5.2
		Noise (dB)		20	25	29	32
375 x 375	0.0609	m cub/sec	0.2222	0.2958	0.368	0.4444	0.5166
		Throw min-max (m)	1.9 - 4.3	2.2 - 4.9	3.1 - 5.5	3.7 - 6.1	4.3 - 6.4
		Noise (dB)		24	29	33	37
450 x 450	0.0878	m cub./sec.	0.3194	0.425	0.5319	0.6375	0.7444
		Throw min-max (m)	2.2 - 5.2	2.8 - 5.8	3.7 - 6.7	4.3 - 7.4	4.9 - 8.0
		Noise (dB)	22	28	33	36	40
525 x 525	0.12	m cub./sec.	0.4347	0.5791	0.7222	0.8694	1.0138
		Throw min-max (m)	2.5 - 6.1	3.4 - 7.1	4.3 - 7.7	4.9 - 8.6	5.8 - 9.2
		Noise (dB)	25	31	36	39	43
600 x 600	0.156	m cub./sec.	0.5666	0.7555	0.9444	11.333	13.222
		Throw min-max (m)	2.8 - 6.7	4.0 - 8.0	4.6 - 4.9	5.8 - 9.8	6.7 - 10.4
		Noise (dB)	27	33	38	43	46

Selection data

CD4

Minimum and maximum throws based on jet terminal velocities of 0.25m/s and 0.75m/s respectively.

CD4-L							
SIZE	AK m sq.	NECK VELOCITY m/s	1.5	2	2.5	3	3.5
		Total Pd mm wg	0.9	1.5	2.3	3.3	4.3
225 x 600	0.0367	m cub/sec	0.0541	0.0708	0.0902	0.1069	0.125
		Throw min-max (m) Shorter side	0.6 - 1.9	0.9 - 1.9	1.3 - 2.2	1.6 - 2.5	1.6 - 2.8
		Throw min-max (m) Longer side	0.9 - 2.5	1.3 - 2.8	1.3 - 2.8	2.2 - 3.4	2.5 - 3.7
		Noise (dB)					23
300 x 150	0.0195	m cub/sec	0.0708	0.0944	0.118	0.1416	0.1652
		Throw min-max (m) Shorter side	0.6 - 1.9	0.9 - 1.9	1.3 - 2.2	1.6 - 2.5	1.6 - 2.8
		Throw min-max (m) Longer side	1.3 - 3.1	1.6 - 3.4	2.2	2.5 - 4.3	3.1 - 4.6
		Noise (dB)				23	27
375 x 150	0.0244	m cub/sec	0.0902	0.118	0.1486	0.1777	0.2083
		Throw min-max (m) Shorter side	0.6 - 1.9	0.9 - 1.9	1.3 - 2.2	1.6 - 2.5	1.6 - 2.8
		Throw min-max (m) Longer side	1.6 - 3.4	1.9 - 4.0	2.5 - 4.3	2.8 - 4.9	3.4 - 5.2
		Noise (dB)			20	24	28
450 x 150	0.0292	m cub/sec	0.1083	0.1416	0.1791	0.2125	0.25
		Throw min-max (m) Shorter side	0.6 - 1.9	0.9 - 1.9	1.3 - 2.2	1.6 - 2.5	1.6 - 2.8
		Throw min-max (m) Longer side	1.6 - 4.0	2.2 - 4.6	2.8 - 4.9	3.1 - 5.5	3.7 - 5.8
		Noise (dB)			22	26	30
300 x 225	0.0292	m cub/sec	0.1083	0.1416	0.1791	0.2125	0.25
		Throw min-max (m) Shorter side	0.9 - 2.5	1.6 - 3.1	1.9 - 3.4	2.2 - 3.7	2.5 - 4.0
		Throw min-max (m) Longer side	1.6 - 3.4	1.9 - 4.0	2.5 - 4.3	2.8 - 4.6	3.1 - 5.2
		Noise (dB)			22	26	30
375 x 225	0.0367	m cub/sec	0.1319	0.1777	0.2222	0.2666	0.3111
		Throw min-max (m) Shorter side	0.9 - 2.5	1.6 - 3.1	1.9 - 3.4	2.2 - 3.7	2.5 - 4.0
		Throw min-max (m) Longer side	1.6 - 4.0	2.2 - 4.6	2.8 - 5.2	3.4 - 5.5	3.7 - 6.1
		Noise (dB)		20	24	28	32
600 x 225	0.0585	m cub/sec	0.2125	0.2833	0.3541	0.425	0.4958
		Throw min-max (m) Shorter side	0.9 - 2.5	1.6 - 3.1	1.9 - 3.4	2.2 - 3.7	2.5 - 4.0
		Throw min-max (m) Longer side	2.2 - 5.5	3.1 - 6.1	3.7 - 7.1	4.3 - 7.7	5.2 - 8.3
		Noise (dB)		24	28	33	33
375 x 300	0.0489	m cub/sec	0.1777	0.2361	0.2958	0.3541	0.4138
		Throw min-max (m) Shorter side	1.6 - 3.4	1.9 - 4.0	2.5 - 4.3	2.8 - 4.9	3.4 - 5.2
		Throw min-max (m) Longer side	1.9 - 4.3	2.5 - 4.9	3.1 - 5.5	3.4 - 5.8	4.0 - 6.1
		Noise (dB)		22	27	31	34

450 x 300	0.0585	m cub/sec	0.2125	0.2833	0.3541	0.425	0.4958
		Throw min-max (m) Shorter side	1.6 - 3.4	1.9 - 4.0	2.5 - 4.3	2.8 - 4.9	3.4 - 5.2
		Throw min-max (m) Longer side	2.2 - 4.9	2.8 - 5.5	3.4 - 6.4	4.0 - 6.7	4.6 - 7.4
		Noise (dB)		24	28	33	36
525 x 300	0.0683	m cub/sec	0.2486	0.3305	0.4138	0.4958	0.5791
		Throw min-max (m) Shorter side	1.6 - 3.4	1.9 - 4.0	2.5 - 4.3	2.8 - 4.9	3.4 - 5.2
		Throw min-max (m) Longer side	2.2 - 5.5	3.1 - 6.4	6.7 - 7.1	4.6 - 7.7	5.2 - 8.3
		Noise (dB)		25	30	34	37
600 x 300	0.078	m cub/sec	0.2833	0.3777	0.4722	0.5666	0.6611
		Throw min-max (m) Shorter side	1.9 - 3.4	1.9 - 4.0	2.5 - 4.3	2.8 - 4.9	3.4 - 5.2
		Throw min-max (m) Longer side	2.5 - 5.8	3.4 - 6.7	4.0 - 7.7	4.9 - 8.6	5.8 - 9.2
		Noise (dB)	21	27	32	35	38
450 x 375	0.0732	m cub/sec	0.2666	0.3541	0.4444	0.5333	0.6208
		Throw min-max (m) Shorter side	1.9 - 4.3	2.5 - 4.9	3.1 - 5.5	3.7 - 6.1	4.3 - 6.4
		Throw min-max (m) Longer side	2.2 - 5.2	2.8 - 5.8	3.7 - 6.4	4.3 - 7.1	4.9 - 7.7
		Noise (dB)	20	26	31	35	38
525 x 375	0.0854	m cub/sec	0.3097	0.4138	0.5166	0.6208	0.7222
		Throw min-max (m) Shorter side	1.9 - 4.3	2.5 - 4.9	3.1 - 5.5	3.7 - 6.1	4.3 - 6.4
		Throw min-max (m) Longer side	2.5 - 5.8	3.1 - 6.7	4.0 - 7.4	4.9 - 8.3	5.5 - 8.9
		Noise (dB)	21	27	32	36	40
600 x 375	0.0975	m cub/sec	0.3541	0.4722	0.5902	0.7083	0.8263
		Throw min-max (m) Shorter side	1.9 - 4.3	2.5 - 4.9	3.1 - 5.5	3.7 - 6.1	4.3 - 6.4
		Throw min-max (m) Longer side	2.8 - 6.4	3.4 - 7.4	4.3 - 8.3	5.2 - 8.9	6.1 - 9.8
		Noise (dB)	22	29	33	37	41
525 x 450	0.102	m cub/sec	0.3736	0.4958	0.6208	0.7458	0.8694
		Throw min-max (m) Shorter side	2.2 - 5.2	2.8 - 5.8	3.4 - 6.7	4.3 - 7.4	4.9 - 8.0
		Throw min-max (m) Longer side	2.5 - 5.8	3.4 - 6.7	4.0 - 7.7	4.9 - 8.6	5.8 - 9.2
		Noise (dB)	23	29	34	38	41
600 x 450	0.117	m cub/sec	0.425	0.5666	0.7083	0.85	0.9916
		Throw min-max (m) Shorter side	2.2 - 5.2	2.8 - 5.8	3.4 - 6.7	4.3 - 7.4	4.9 - 8.0
		Throw min-max (m) Longer side	2.8 - 6.4	3.7 - 7.7	4.6 - 8.6	5.5 - 9.5	6.4 - 10.1
		Noise (dB)	24	31	36	39	43
600 x 525	0.136	m cub/sec	0.4958	0.6611	0.8263	0.9916	1.1569
		Throw min-max (m) Shorter side	2.5 - 6.1	3.4 - 7.1	4.3 - 7.7	4.9 - 8.6	5.8 - 9.2
		Throw min-max (m) Longer side	2.8 - 6.7	3.7 - 8.0	4.6 - 8.9	5.5 - 9.8	6.4 - 10.4
		Noise (dB)	26	32	37	41	44



Supplies Ltd

Grilles & diffusers

Louvres

Fire / Fire smoke dampers

Volume control dampers



HVC Supplies Ltd

Bradley Road

Stourbridge

West Midlands

DY8 1UZ

United Kingdom

Telephone:

+44 (0)1384 376555

Fax:

+44 (0)1384 392555



Incorporating:



All details within this brochure are correct at time of going to print. However HVC's policy is one of continual product development. The right is reserved to alter any details published in this brochure without any prior notice. Any changes will appear on www.h-v-c.com as soon as is practically possible.

All information in this brochure is designed to be used for informative purposes only. HVC will not be legally bound by anything contained within this publication, or any other information distributed.

All references to companies not part of the HVC group of companies are used with the permission of their respective owners.