



Incorporating



V2.0



Product spec >>>

> Series DJ - Drum jet diffusers

Diffusers

Drum jets (Premium)

Recommended for:

Wall, ceiling & duct

Supply

Overview

Exceptional throw

Throw completely adjustable

Drum jet diffusers offer high levels of adjustability & an exceptionally long throw. They are available in eight standard sizes, or any length with one of two heights.



Specifications:

Materials:	Extruded aluminium throughout. Brush seals surround drum for smooth adjustment.
Construction:	Frames have punched in corners. Drum bolted into frame. Blades held within cassette. Cassette held in drum by design.
Fixings:	Standard - None. Optional - Countersunk face fixing holes & colour matched screws.
Sizes:	8 standard sizes - See table. Longer lengths optional.
Finish:	Standard - Satin anodised. Optional - Polyester powder coated to any RAL / BS colour.

Exceptional throw

With a large free area when blades are fully open, drum jets are able to handle large volumes of air with minimal noise and pressure drop generation. This makes them perfect for large open plan areas where large throws are required to ventilate the whole area.

Adjustability

The rotating drum and individually adjustable deflector blades creates a unit which adjusts in both planes. Enabling targeted throws to be created at specific areas, or wide throw patterns for maximum affected area.

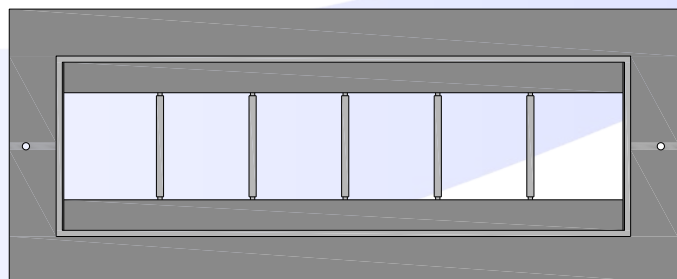

Series DJ-P

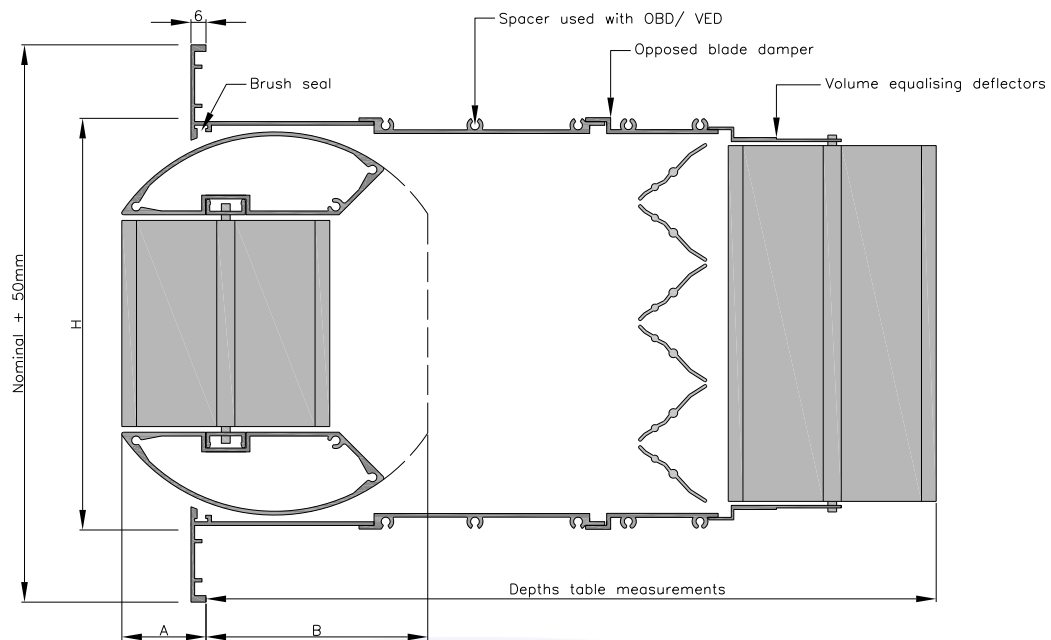

Sizes								
Size	Nominal (mm)		Dimensions (mm)		Overall (mm)		Depths	Mass (kg)
	W	H	A	B	W	H		
1	261	170	34	90	307	220	Diffuser = 85mm c/w OBD = 205mm c/w VED = 244mm c/w OBD & VED = 292mm	1.5
2	337				383			1.7
3	490				536			2
4	642				688			2.5
5	540	271	64	108	586	324		5.5
6	667				713			6.5
7	794				840			7
8	921				967			7.5

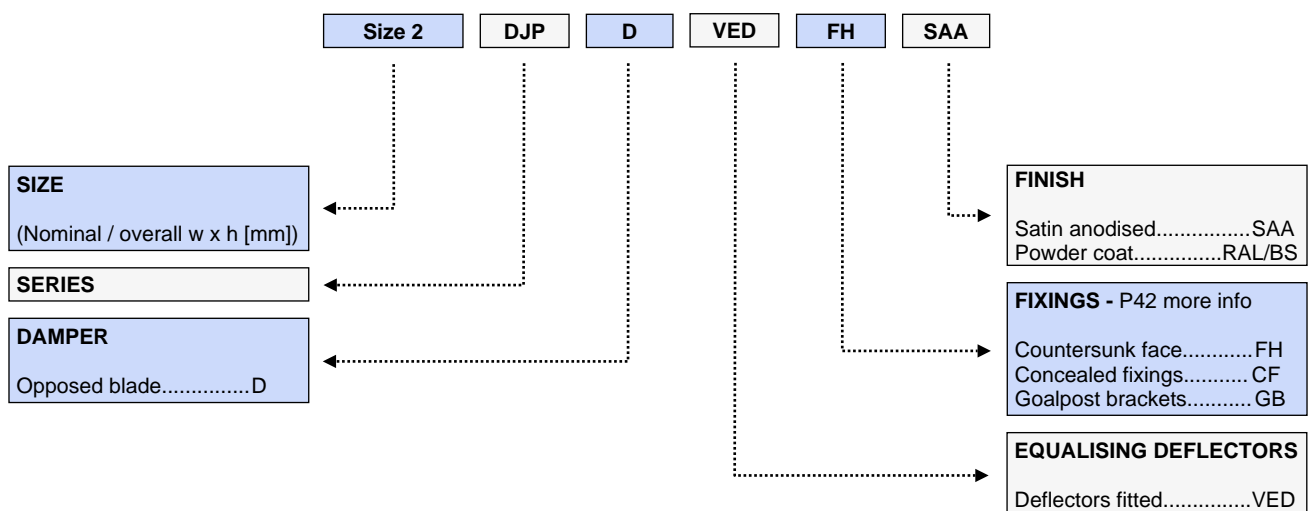

Diffusers

Drum jets (Stock)

Recommended for:

Wall, ceiling & duct

Supply

Overview

Exceptional throw

Throw completely adjustable

Drum jet diffusers offer high levels of adjustability & an exceptionally long throw. The stock range is available in eight standard sizes, in RAL 9010 or satin anodised finish.



Specifications:

Materials:	Extruded aluminium throughout. Brush seals surround drum for smooth adjustment.
Construction:	Frames have punched in corners. Drum bolted into frame. Blades held in drum with screws.
Fixings:	Countersunk face fixing holes & RAL 9010 painted screws.
Sizes:	8 standard sizes - See table.
Finish:	Standard - Satin anodised (AA5). RAL 9010.

Exceptional throw

With a large free area when blades are fully open, drum jets are able to handle large volumes of air with minimal noise and pressure drop generation. This makes them perfect for large open plan areas where large throws are required to ventilate the whole area.

Adjustability

The rotating drum and individually adjustable deflector blades creates a unit which adjusts in both planes. Enabling targeted throws to be created at specific areas, or wide throw patterns for maximum affected area.

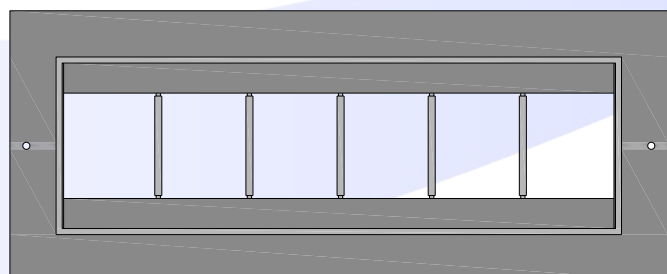

Please note:
Position of fixing holes will vary with size.

Series DJ-S

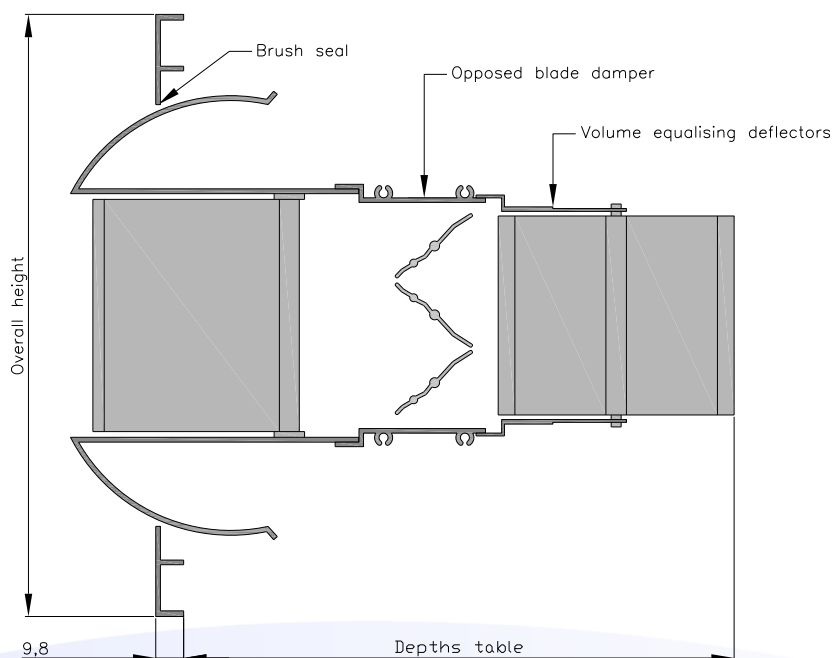

Sizes								
Size	Nominal (mm)		Overall (mm)		Blade pitch	Depth	Depth c/w OBD	Depth c/w OBD & VED
	W	H	W	H				
A	244	164	297	208	76	62	106	194
B	321		373					
C	473		525					
D	625		678					
E	524	259	576	303	127	100	144	232
F	651		703					
G	778		830					
H	905		957					

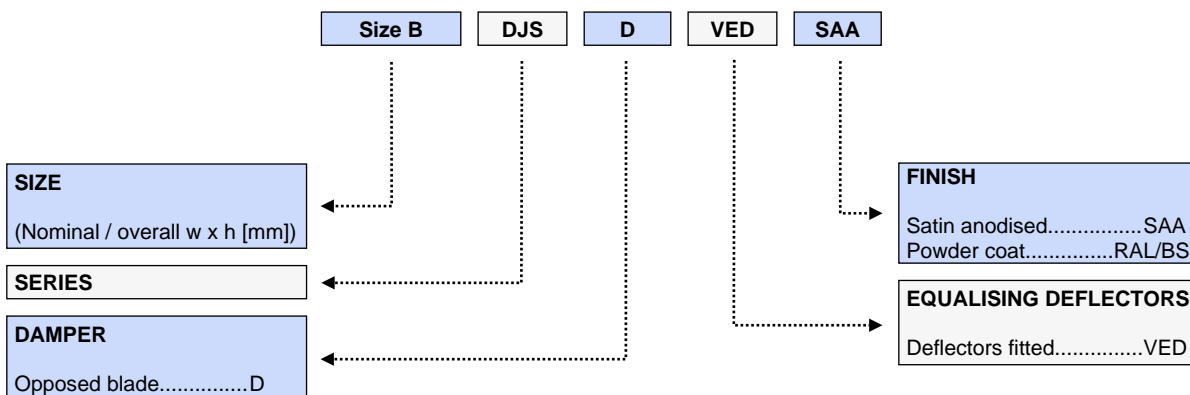

Selection data

DJ

SPECIAL NOTE: Use left hand size line for throw. Right hand size line for Noise/pressure.

Throw values based on an isothermal application, to a terminal velocity of 0.25m/s with straight vanes.

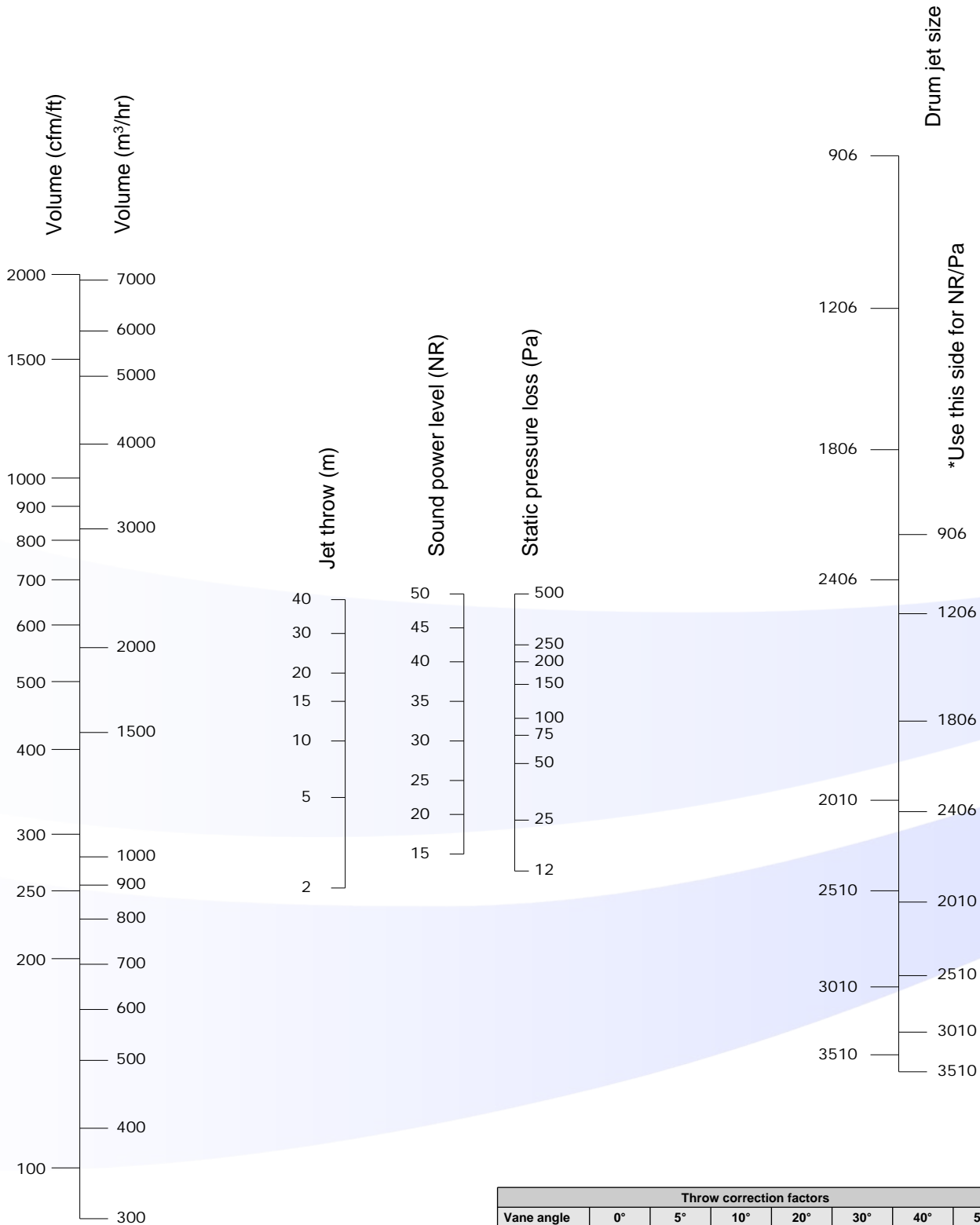

Ancillaries

Saddle adaptors - SA

Overview

Normally used with diffusers best suited to fitment onto ductwork like drum jet diffusers, saddle adaptors allow a quadrilateral shaped grille to fit a circular duct.

Specifications:

Materials: Galvanised steel throughout

Construction: Brake press formed.

Fixings: None.

Plenum riveted to ductwork.

Grille affixed to plenum flanges.

Flange: Standard - Inturned (as shown in picture).

Grille flange would be be outturned if duct diameter is equal to or more than the grille nominal size.

Finish: Standard - Galvanised steel.

Optional - Painted to any RAL / BS colour.

Tapers

When the grille nominal size is not equal to the duct diameter, the adaptor will be tapered as in the photo.

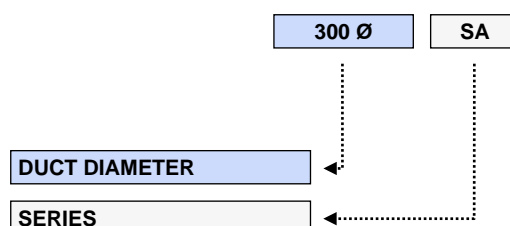
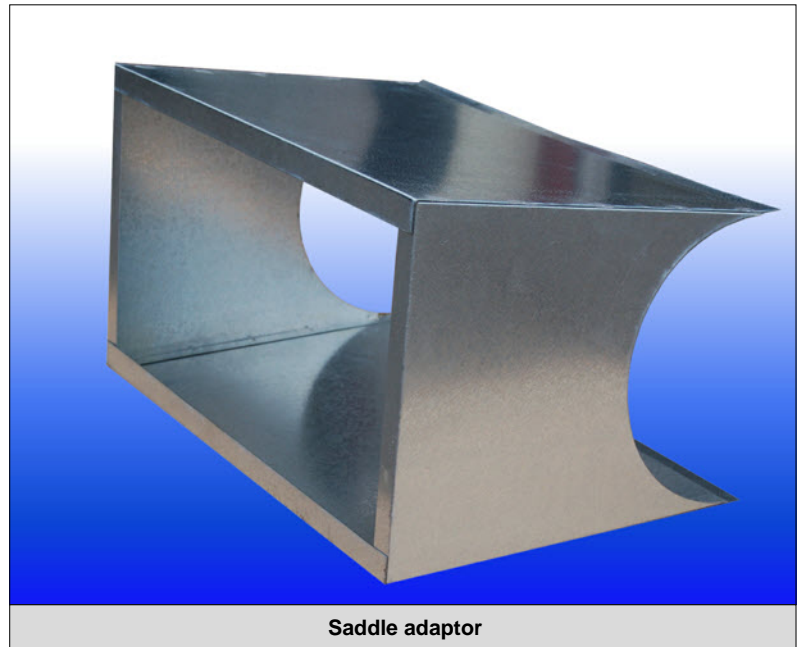



Supplies Ltd

Grilles & diffusers

Louvres

Fire / Fire smoke dampers

Volume control dampers



www.h-v-c.com



All details within this brochure are correct at time of going to print. However HVC's policy is one of continual product development. The right is reserved to alter any details published in this brochure without any prior notice. Any changes will appear on www.h-v-c.com as soon as is practically possible.

All information in this brochure is designed to be used for informative purposes only. HVC will not be legally bound by anything contained within this publication, or any other information distributed.

All references to companies not part of the HVC group of companies are used with the permission of their respective owners.