

Tuesday, 21.June 2016

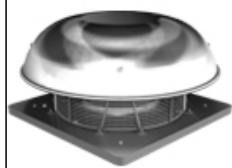

Roof fans horizontal outlet

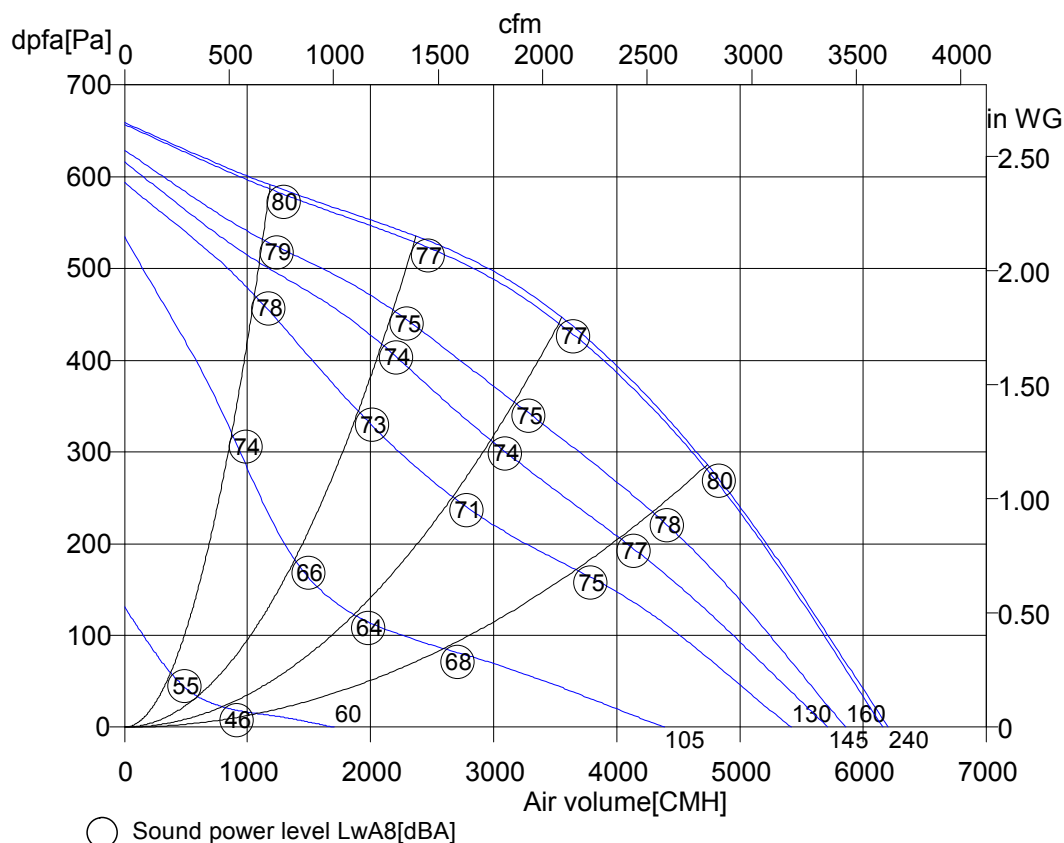

DHE 450-4 E.6FA

Art. No.	A43-45000
U[V]	1~230
f[Hz]	50
P[kW]	0.89
I[A]	4.30
n[1/min]	1400
C[μF]	20
tR[°C]	45
dpst[Pa]	-
Delta I[%]	40
Ia/In	3.9
IP	54
Weight[kG]	34.8
Wir. diag.	01.024
Overall eff [%]	48.5
Eff. Grade N	49
Power input [kW]	0.880
Air flow [m³/h]	3436
Press. [Pa]	450
Speed [1/min]	1404
Velocity [m/s]	1.70
Lot11 eff [%]	51.4

Octave sound power level

f[Hz]	125	250	500	1000	2000	4000	8000
LwA8[dBA]:	-15	-7	-5	-7	-7	-14	-18
LwA5[dBA]:	-15	-12	-10	-9	-12	-19	-27

Tuesday, 21.June 2016

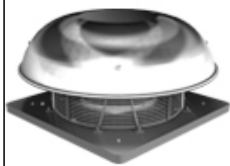

Roof fans horizontal outlet

DHE 450-4 E.6FA

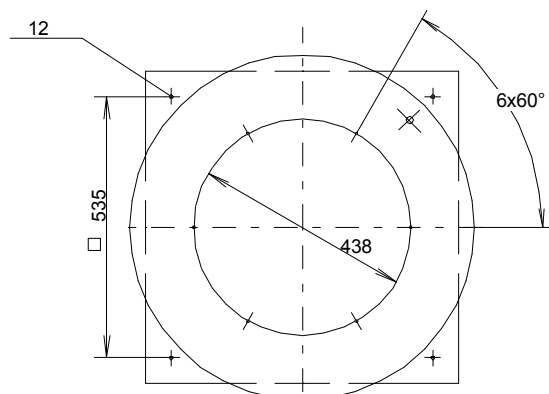
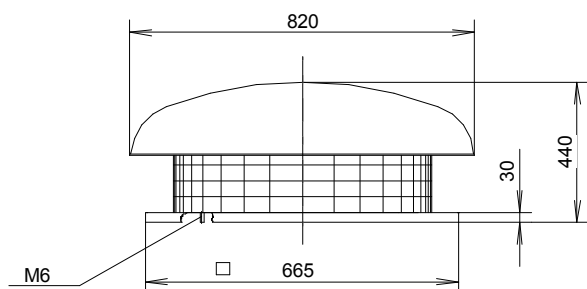

Tuesday, 21.June 2016

Pos.	Pieces	Description	Price																														
		<p>Roof fans horizontal outlet</p> <p>Base frame with bolts for tightening of inlet accessories and retracted inlet cone made of galvanized steel. Rain hood made from seawater resistant aluminium. Motor supporting plate with integrated protection guard made from plastic coated round bar steel.</p> <p>Fans are equipped with backward curved high efficiency plastic impellers up to size 560, from size 630 made from seawater resistant aluminium, mounted onto the rotor of a speed controllable external rotor motor. Balanced on two levels according to quality level G 6.3 DIN/ISO1940. Motor closed, protection class IP 44/54 with protection against humidity and thermal contacts wired in windings from size 355.</p> <p>Maintenance free ball bearings, closed on both sides, sealed for life. Easy access to the terminal box (not connected) in IP 54 under rain hood.</p> <p>Reference to Directives: Declaration of incorporation and operating instruction are according to Machinery Directive 2006/42/EC, CE identification in accordance to EMC-Directive 2014/30/EU, Low Voltage Directive 2014/35/EU and the Ecodesign-Directive 2009/125/EC.</p> <p>Nominal data</p> <table><tr><td>Type</td><td>DHE 450-4 E.6FA</td></tr><tr><td>Article no.</td><td>A43-45000</td></tr><tr><td>Voltage[V]</td><td>1~230</td></tr><tr><td>Frequency[Hz]</td><td>50</td></tr><tr><td>Power P1[kW]</td><td>0.89</td></tr><tr><td>Current I[A]</td><td>4.30</td></tr><tr><td>Speed n[1/min]</td><td>1400</td></tr><tr><td>Capacitor C[µF]</td><td>20</td></tr><tr><td>Max. air temp.tR[°C]</td><td>45</td></tr><tr><td>Min. pressure dpst[Pa]</td><td>-</td></tr><tr><td>Delta I[%]</td><td>40</td></tr><tr><td>Startup current Ia/In</td><td>3.9</td></tr><tr><td>Protection-mode</td><td>IP 54</td></tr><tr><td>Weight[kg]</td><td>34.8</td></tr><tr><td>wiring diagram</td><td>01.024</td></tr></table>	Type	DHE 450-4 E.6FA	Article no.	A43-45000	Voltage[V]	1~230	Frequency[Hz]	50	Power P1[kW]	0.89	Current I[A]	4.30	Speed n[1/min]	1400	Capacitor C[µF]	20	Max. air temp.tR[°C]	45	Min. pressure dpst[Pa]	-	Delta I[%]	40	Startup current Ia/In	3.9	Protection-mode	IP 54	Weight[kg]	34.8	wiring diagram	01.024	
Type	DHE 450-4 E.6FA																																
Article no.	A43-45000																																
Voltage[V]	1~230																																
Frequency[Hz]	50																																
Power P1[kW]	0.89																																
Current I[A]	4.30																																
Speed n[1/min]	1400																																
Capacitor C[µF]	20																																
Max. air temp.tR[°C]	45																																
Min. pressure dpst[Pa]	-																																
Delta I[%]	40																																
Startup current Ia/In	3.9																																
Protection-mode	IP 54																																
Weight[kg]	34.8																																
wiring diagram	01.024																																

Tuesday, 21.June 2016

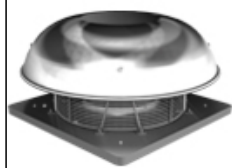

Roof fans horizontal outlet

DHE 450-4 E.6FA

Einphasenwechselstrommotor mit Betriebskondensator und Thermostatschalter.
Bei Verwendung von RE Steuergeräten TB mit der Wicklung in Reihe schalten.
Hierfür Brücke (x) einlegen und gestrichelt gezeichnete Anschlüsse belegen.

Single phase A.C. motor with operating capacitor and thermostatic switch.
Thermostatic switch wired in series with windings if RE controllers are used.
Insert bridge (x) and wire connections shon as dash-line on the drawing.

Moteur monophasé avec condensateur permanent et interrupteur thermo-
statique branché en série avec le bobinage en cas de branchement avec des
régulateurs RE. Mettre un pont (x) et brancher toutes les connexions
dessinées en hachuré.

Rechtslauf
clockwise
rotation horaire

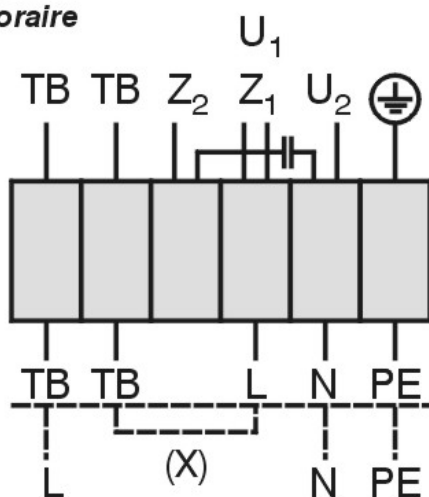

U₁ braun / brown / brun
U₂ blau / blue / bleu
Z₁ schwarz / black / noir
Z₂ orange / orange / orange

TB weiß / white / blanc
PE gelb-grün
yellow-green
jaune-vert

01.024

TK3-20010