

Thursday, 05.May 2016

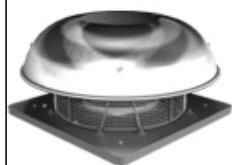

## Roof fans horizontal outlet

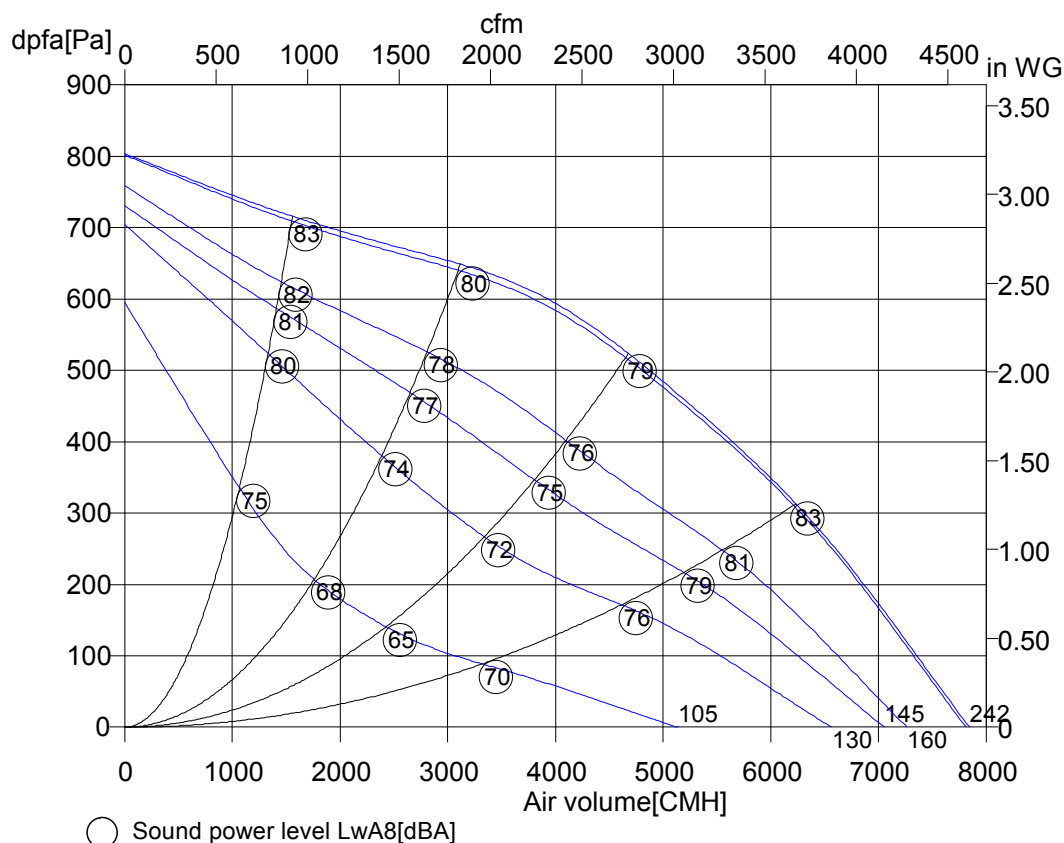

### DHE 500-4 E.6HF

Art. No.	A43-50000
U[V]	1~230
f[Hz]	50
P[kW]	1.42
I[A]	6.40
n[1/min]	1395
C[μF]	30
tR[°C]	40
dpst[Pa]	-
Delta I[%]	39
Ia/In	3.4
IP	54
Weight[kG]	
Wir. diag.	01.024
Overall eff [%]	47.7
Eff. Grade N	45
Power input [kW]	1.42
Air flow [m³/h]	4745
Press. [Pa]	509
Speed [1/min]	1393
Velocity [m/s]	2.34
Lot11 eff [%]	53.9

### Octave sound power level

f[Hz]	125	250	500	1000	2000	4000	8000
LwA8[dBA]:	-9	-8	-8	-4	-9	-16	-23
LwA5[dBA]:	-15	-10	-10	-11	-12	-17	-23

Thursday, 05.May 2016

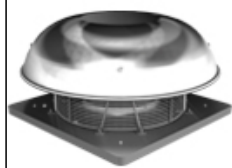

## Roof fans horizontal outlet

### DHE 500-4 E.6HF

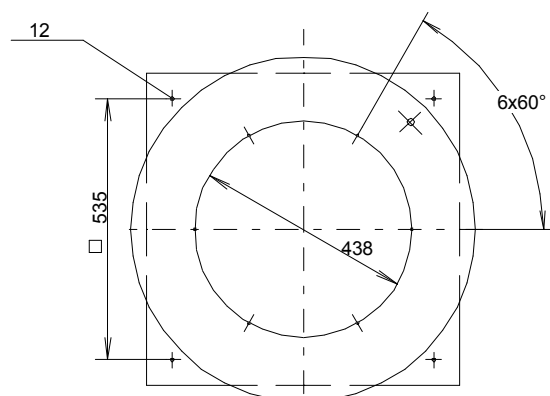
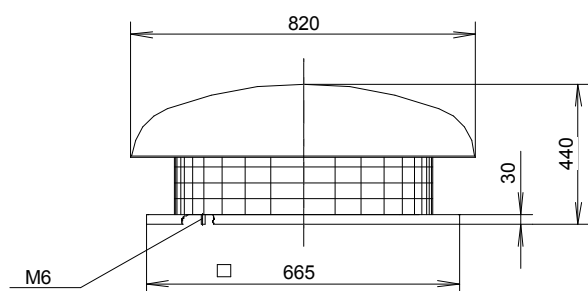

Thursday, 05.May 2016

Pos.	Pieces	Description	Price																														
		<p>Roof fans horizontal outlet</p> <p>Base frame with bolts for tightening of inlet accessories and retracted inlet cone made of galvanized steel. Rain hood made from seawater resistant aluminium. Motor supporting plate with integrated protection guard made from plastic coated round bar steel.</p> <p>Fans are equipped with backward curved high efficiency plastic impellers up to size 560, from size 630 made from seawater resistant aluminium, mounted onto the rotor of a speed controllable external rotor motor. Balanced on two levels according to quality level G 6.3 DIN/ISO1940. Motor closed, protection class IP 44/54 with protection against humidity and thermal contacts wired in windings from size 355.</p> <p>Maintenance free ball bearings, closed on both sides, sealed for life. Easy access to the terminal box (not connected) in IP 54 under rain hood.</p> <p>Reference to Directives: Declaration of incorporation and operating instruction are according to Machinery Directive 2006/42/EC, CE identification in accordance to EMC-Directive 2014/30/EU, Low Voltage Directive 2014/35/EU and the Ecodesign-Directive 2009/125/EC.</p> <p><b>Nominal data</b></p> <table><tr><td>Type</td><td>DHE 500-4 E.6HF</td></tr><tr><td>Article no.</td><td>A43-50000</td></tr><tr><td>Voltage[V]</td><td>1~230</td></tr><tr><td>Frequency[Hz]</td><td>50</td></tr><tr><td>Power P1[kW]</td><td>1.42</td></tr><tr><td>Current I[A]</td><td>6.40</td></tr><tr><td>Speed n[1/min]</td><td>1395</td></tr><tr><td>Capacitor C[μF]</td><td>30</td></tr><tr><td>Max. air temp.tR[°C]</td><td>40</td></tr><tr><td>Min. pressure dpst[Pa]</td><td>-</td></tr><tr><td>Delta I[%]</td><td>39</td></tr><tr><td>Startup current Ia/In</td><td>3.4</td></tr><tr><td>Protection-mode</td><td>IP 54</td></tr><tr><td>Weight[kg]</td><td></td></tr><tr><td>wiring diagram</td><td>01.024</td></tr></table>	Type	DHE 500-4 E.6HF	Article no.	A43-50000	Voltage[V]	1~230	Frequency[Hz]	50	Power P1[kW]	1.42	Current I[A]	6.40	Speed n[1/min]	1395	Capacitor C[μF]	30	Max. air temp.tR[°C]	40	Min. pressure dpst[Pa]	-	Delta I[%]	39	Startup current Ia/In	3.4	Protection-mode	IP 54	Weight[kg]		wiring diagram	01.024	
Type	DHE 500-4 E.6HF																																
Article no.	A43-50000																																
Voltage[V]	1~230																																
Frequency[Hz]	50																																
Power P1[kW]	1.42																																
Current I[A]	6.40																																
Speed n[1/min]	1395																																
Capacitor C[μF]	30																																
Max. air temp.tR[°C]	40																																
Min. pressure dpst[Pa]	-																																
Delta I[%]	39																																
Startup current Ia/In	3.4																																
Protection-mode	IP 54																																
Weight[kg]																																	
wiring diagram	01.024																																

Thursday, 05.May 2016

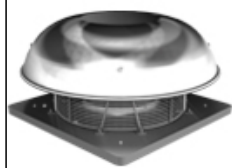

## Roof fans horizontal outlet

### DHE 500-4 E.6HF

Einphasenwechselstrommotor mit Betriebskondensator und Thermostatschalter.  
Bei Verwendung von RE Steuergeräten TB mit der Wicklung in Reihe schalten.  
Hierfür Brücke (x) einlegen und gestrichelt gezeichnete Anschlüsse belegen.

**Single phase A.C. motor with operating capacitor and thermostatic switch.**  
**Thermostatic switch wired in series with windings if RE controllers are used.**  
**Insert bridge (x) and wire connections shown as dash-line on the drawing.**

**Moteur monophasé avec condensateur permanent et interrupteur thermostatique branché en série avec le bobinage en cas de branchement avec des régulateurs RE. Mettre un pont (x) et brancher toutes les connexions dessinées en hachuré.**

Rechtslauf  
clockwise  
rotation horaire

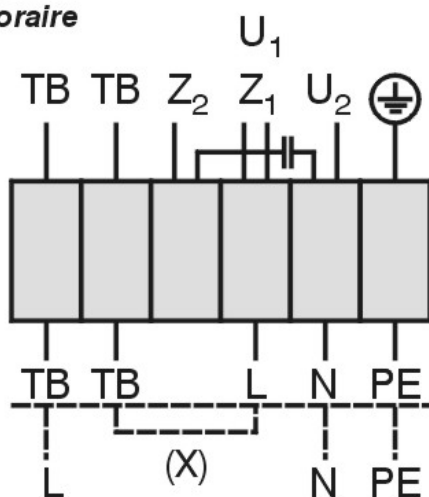

U<sub>1</sub> braun / brown / brun  
U<sub>2</sub> blau / blue / bleu  
Z<sub>1</sub> schwarz / black / noir  
Z<sub>2</sub> orange / orange / orange

TB weiß / white / blanc  
PE gelb-grün  
yellow-green  
jaune-vert

01.024

TK3-20010